

TxDOT Highway Lighting Agreement

Public Utilities Board

July 10, 2017



TxDOT & 35 Express

Nearing completion of portion of 35Express project in Denton

- Highway lighting will be installed in August 2017
- TxDOT needs a decision on type of lighting
- City staff has calculated estimated costs for lighting
- Legal staff has prepared draft agreements

Safety vs. Continuous

Safety Lighting

- Required to be installed
- 114 lamps
- 56 wallpacks
- Paid by TxDOT
- Estimated \$10,500 per year to operate

Continuous Lighting

- Not required
- 278 lamps
- 56 wallpacks
- Paid by City of Denton
- Estimated \$20,600 per year to operate

Continuous

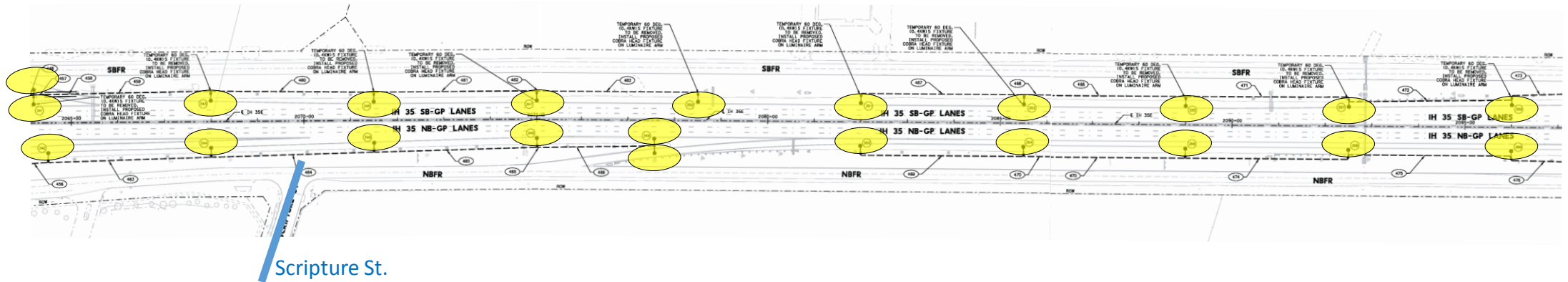

Safety

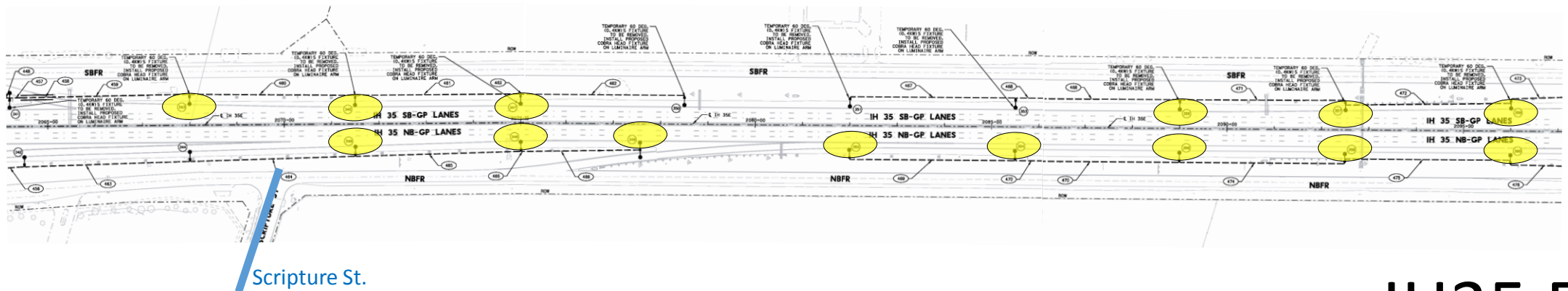

IH35 E

Continuous

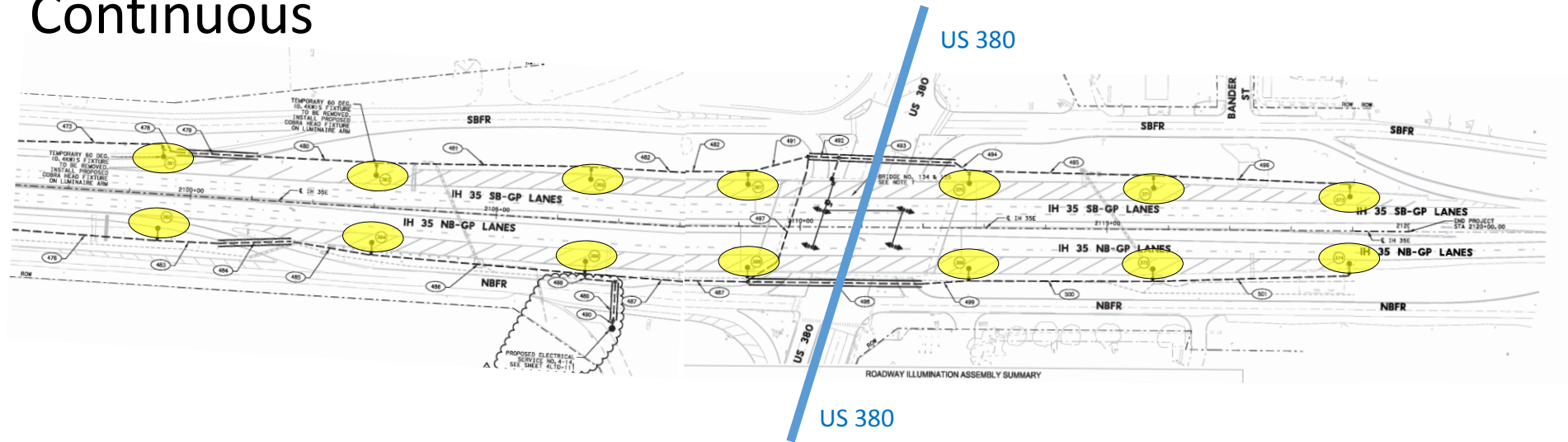

Safety

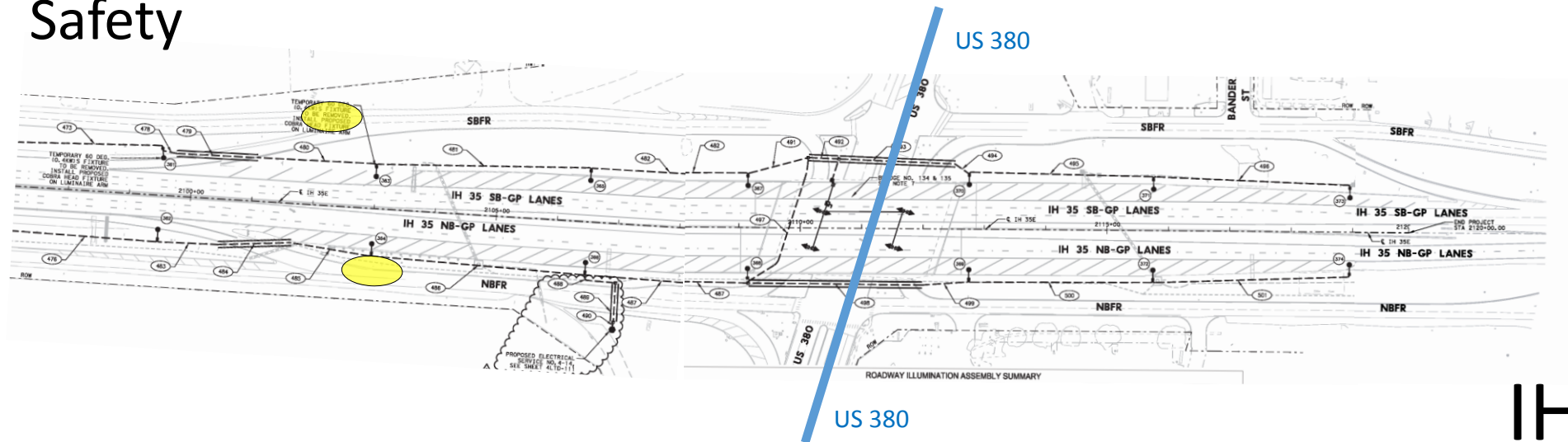

IH35 E

Continuous

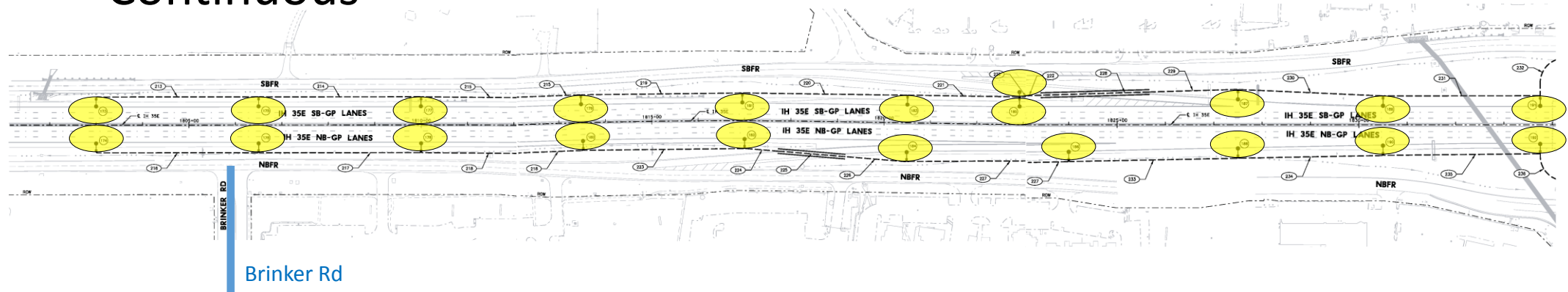

Safety

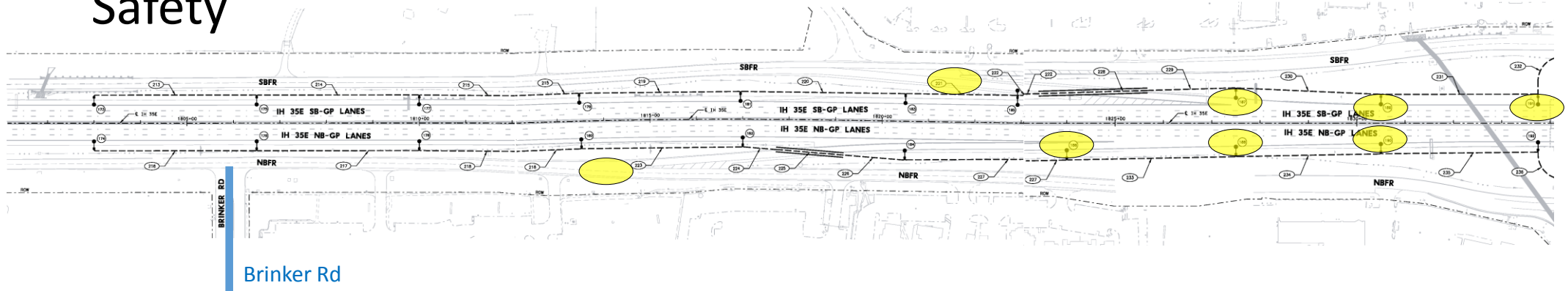

IH35 E

Safety vs. Continuous

Safety Lighting

Estimated savings of \$20,600 per year as compared to continuous lighting

Continuous Lighting

- Safer driving conditions
 - Increase nighttime visibility
 - Lower night-to-day accident ratio
- Cities South of Denton have chosen continuous lighting
- Additional visibility for law enforcement personnel and highway work

TxDOT Highway Illumination Manual

Safety Lighting

- Requires lighting to be installed at:
 - Interchanges
 - Intersections
 - Other points of nighttime hazard

Continuous Lighting

- Provides uniform illumination on:
 - All main lanes
 - All direct connections
- Complete lighting for all interchanges

Benefits of Continuous Lighting

- Safer driving conditions
 - Increase nighttime visibility
 - Lower night-to-day accident ratio
- Cities South of Denton have chosen continuous lighting
- Additional visibility for law enforcement personnel and for highway work

Recommendation

Option 1:

Recommend that the City Council approve the continuous lighting agreement.

Option 2:

Recommend that the City Council approve the safety lighting agreement.



Continuous

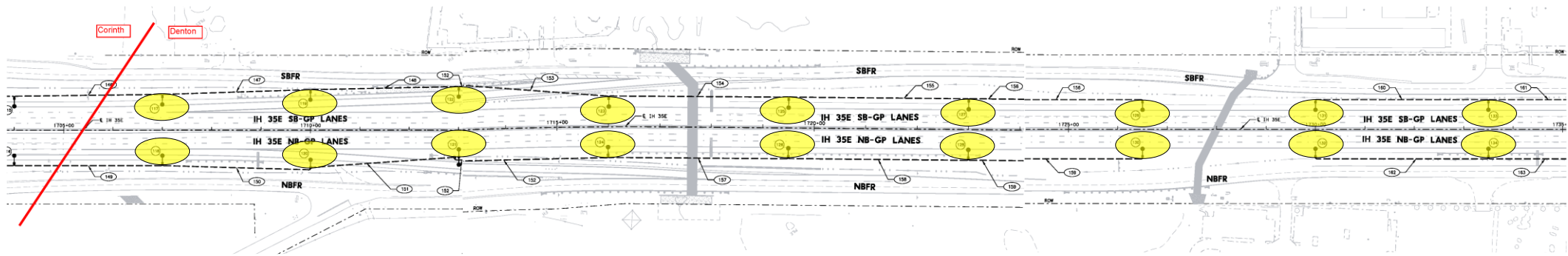

Continuous

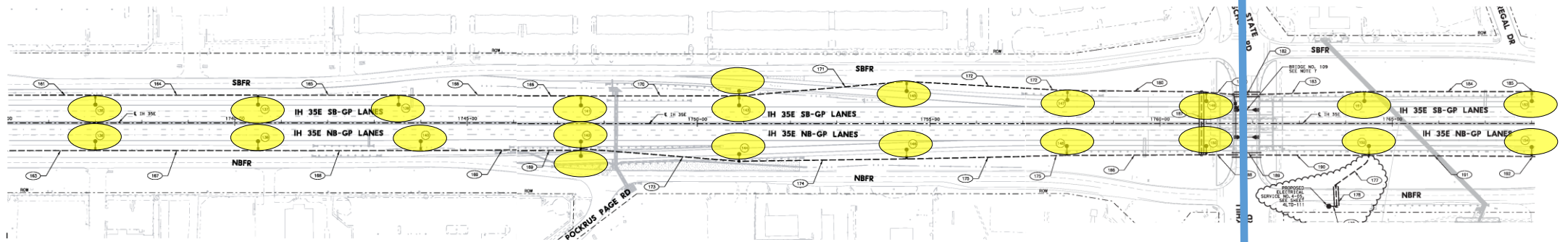

Safety

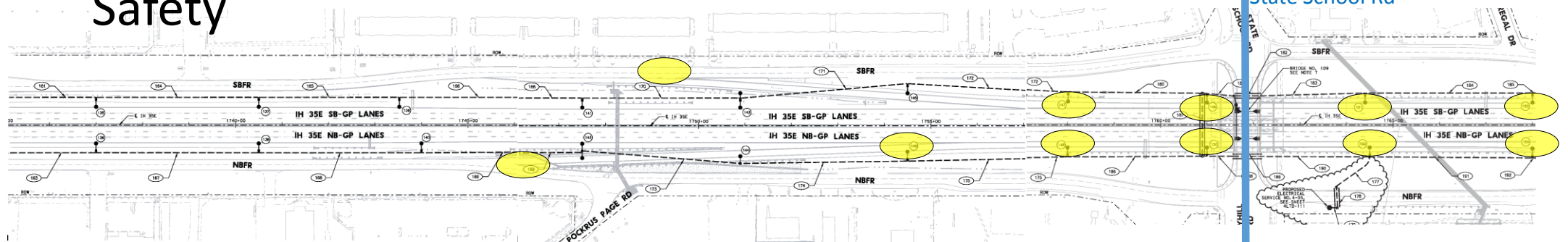

IH35 E

Continuous

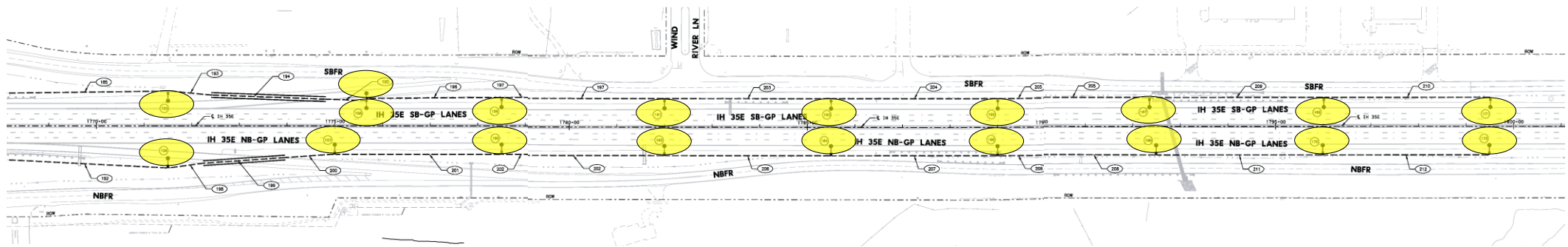

Safety

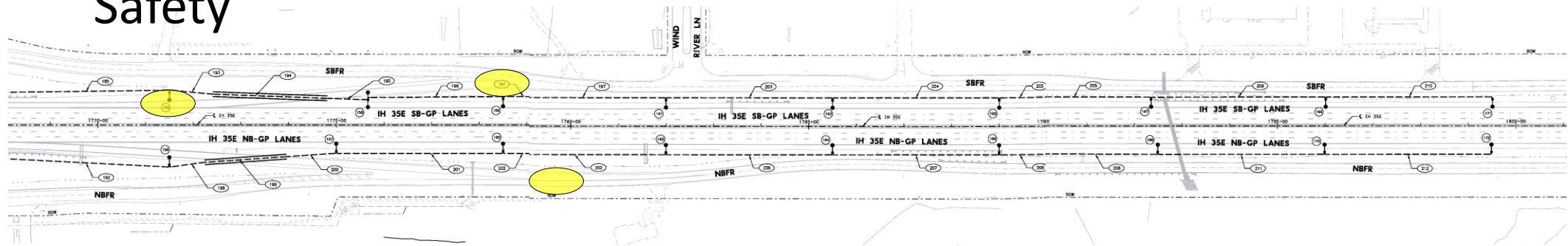

IH35 E

Continuous

Loop 288

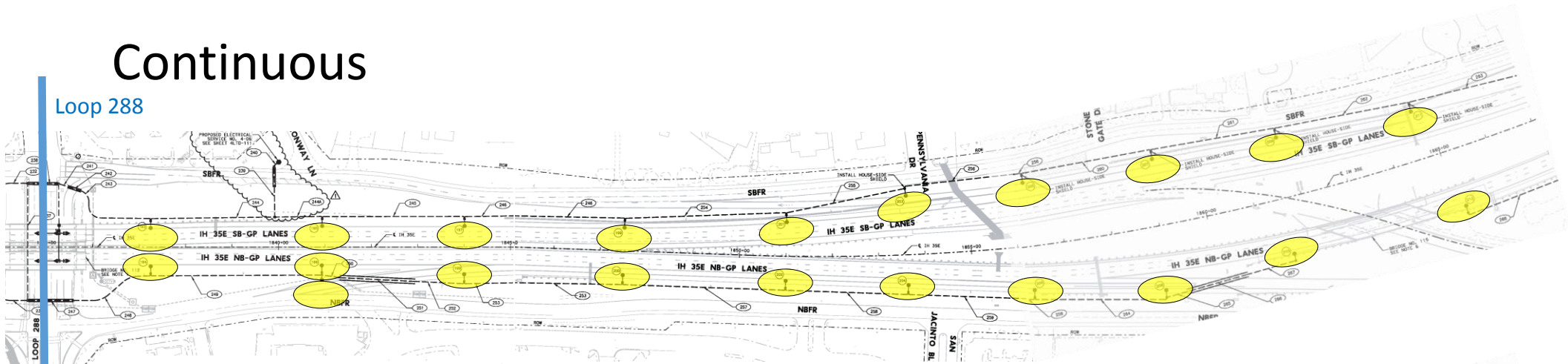

Loop 288

Safety

Loop 288

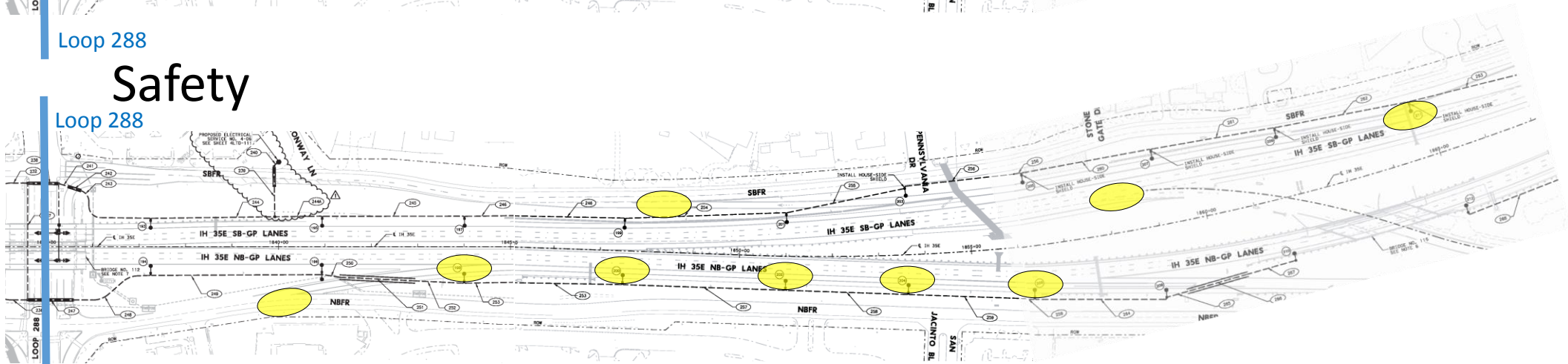

Loop 288

IH35 E

Continuous

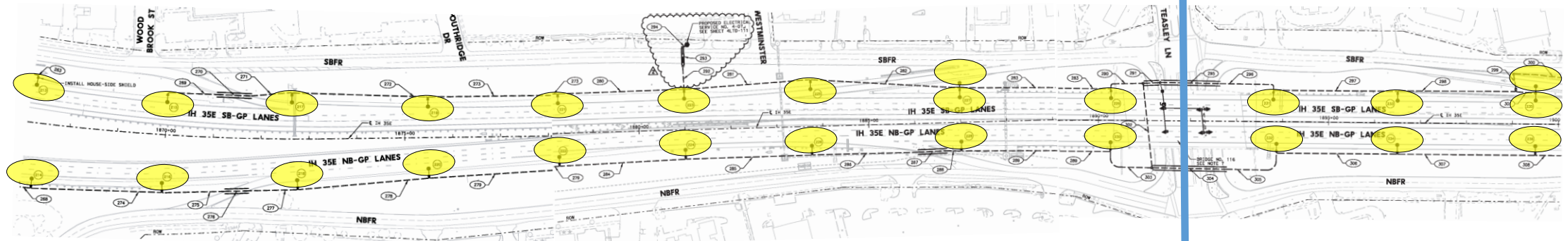

Teasley Ln

Teasley Ln

Safety

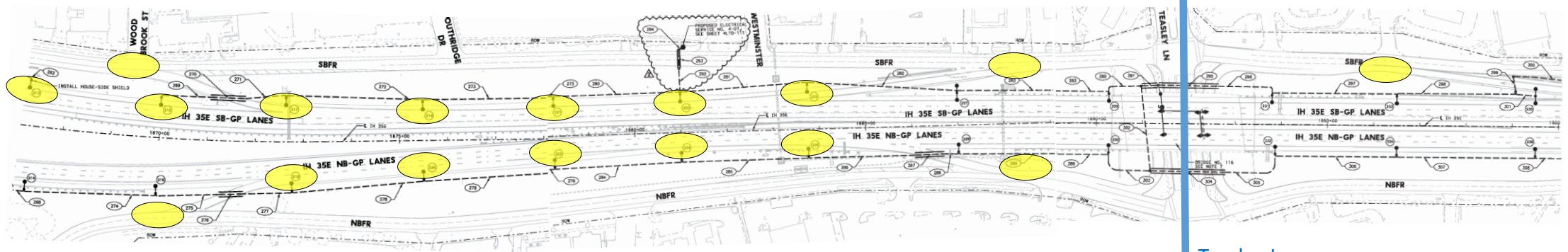

Teasley Ln

Teasley Ln

IH35 E

Diagram illustrating a road layout with safety zones (yellow ovals) and lane markings. The diagram shows a multi-lane highway with various lane configurations and safety zones marked by yellow ovals. Key labels include:

- SBFR** (Southbound Frontage Road)
- NBFR** (Northbound Frontage Road)
- IH 35E SB-GP LANES** (Interstate Highway 35E Southbound General Purpose Lanes)
- IH 35E NB-GP LANES** (Interstate Highway 35E Northbound General Purpose Lanes)
- SAN BLASS BLVD**
- MEADOW ST**
- UP RAILRO** (Up Railroad)
- LOUST ST**
- Centre Pl. Dr.**

Additional notes and markings include:

- TEMPORARY NO STOP IN HEAD FIXTURE TO BE REMOVED UP IN APPROX 100' LEAD FEATURE ON LANE 10' AND
- 1500+00
- 1510+00
- 1520+00
- 1530+00
- 1540+00
- 1550+00
- 1560+00
- 1570+00
- 1580+00
- 1590+00
- 1600+00
- 1610+00
- 1620+00
- 1630+00
- 1640+00
- 1650+00
- 1660+00
- 1670+00
- 1680+00
- 1690+00
- 1700+00
- 1710+00
- 1720+00
- 1730+00
- 1740+00
- 1750+00
- 1760+00
- 1770+00
- 1780+00
- 1790+00
- 1800+00
- 1810+00
- 1820+00
- 1830+00
- 1840+00
- 1850+00
- 1860+00
- 1870+00
- 1880+00
- 1890+00
- 1900+00
- 1910+00
- 1920+00
- 1930+00
- 1940+00
- 1950+00
- 1960+00
- 1970+00
- 1980+00
- 1990+00
- 2000+00
- 2010+00
- 2020+00
- 2030+00
- 2040+00
- 2050+00
- 2060+00
- 2070+00
- 2080+00
- 2090+00
- 2100+00
- 2110+00
- 2120+00
- 2130+00
- 2140+00
- 2150+00
- 2160+00
- 2170+00
- 2180+00
- 2190+00
- 2200+00
- 2210+00
- 2220+00
- 2230+00
- 2240+00
- 2250+00
- 2260+00
- 2270+00
- 2280+00
- 2290+00
- 2300+00
- 2310+00
- 2320+00
- 2330+00
- 2340+00
- 2350+00
- 2360+00
- 2370+00
- 2380+00
- 2390+00
- 2400+00
- 2410+00
- 2420+00
- 2430+00
- 2440+00
- 2450+00
- 2460+00
- 2470+00
- 2480+00
- 2490+00
- 2500+00
- 2510+00
- 2520+00
- 2530+00
- 2540+00
- 2550+00
- 2560+00
- 2570+00
- 2580+00
- 2590+00
- 2600+00
- 2610+00
- 2620+00
- 2630+00
- 2640+00
- 2650+00
- 2660+00
- 2670+00
- 2680+00
- 2690+00
- 2700+00
- 2710+00
- 2720+00
- 2730+00
- 2740+00
- 2750+00
- 2760+00
- 2770+00
- 2780+00
- 2790+00
- 2800+00
- 2810+00
- 2820+00
- 2830+00
- 2840+00
- 2850+00
- 2860+00
- 2870+00
- 2880+00
- 2890+00
- 2900+00
- 2910+00
- 2920+00
- 2930+00
- 2940+00
- 2950+00
- 2960+00
- 2970+00
- 2980+00
- 2990+00
- 3000+00
- 3010+00
- 3020+00
- 3030+00
- 3040+00
- 3050+00
- 3060+00
- 3070+00
- 3080+00
- 3090+00
- 3100+00
- 3110+00
- 3120+00
- 3130+00
- 3140+00
- 3150+00
- 3160+00
- 3170+00
- 3180+00
- 3190+00
- 3200+00
- 3210+00
- 3220+00
- 3230+00
- 3240+00
- 3250+00
- 3260+00
- 3270+00
- 3280+00
- 3290+00
- 3300+00
- 3310+00
- 3320+00
- 3330+00
- 3340+00
- 3350+00
- 3360+00
- 3370+00
- 3380+00
- 3390+00
- 3400+00
- 3410+00
- 3420+00
- 3430+00
- 3440+00
- 3450+00
- 3460+00
- 3470+00
- 3480+00
- 3490+00
- 3500+00
- 3510+00
- 3520+00
- 3530+00
- 3540+00
- 3550+00
- 3560+00
- 3570+00
- 3580+00
- 3590+00
- 3600+00
- 3610+00
- 3620+00
- 3630+00
- 3640+00
- 3650+00
- 3660+00
- 3670+00
- 3680+00
- 3690+00
- 3700+00
- 3710+00
- 3720+00
- 3730+00
- 3740+00
- 3750+00
- 3760+00
- 3770+00
- 3780+00
- 3790+00
- 3800+00
- 3810+00
- 3820+00
- 3830+00
- 3840+00
- 3850+00
- 3860+00
- 3870+00
- 3880+00
- 3890+00
- 3900+00
- 3910+00
- 3920+00
- 3930+00
- 3940+00
- 3950+00
- 3960+00
- 3970+00
- 3980+00
- 3990+00
- 4000+00
- 4010+00
- 4020+00
- 4030+00
- 4040+00
- 4050+00
- 4060+00
- 4070+00
- 4080+00
- 4090+00
- 4100+00
- 4110+00
- 4120+00
- 4130+00
- 4140+00
- 4150+00
- 4160+00
- 4170+00
- 4180+00
- 4190+00
- 4200+00
- 4210+00
- 4220+00
- 4230+00
- 4240+00
- 4250+00
- 4260+00
- 4270+00
- 4280+00
- 4290+00
- 4300+00
- 4310+00
- 4320+00
- 4330+0

17/11

Continuous

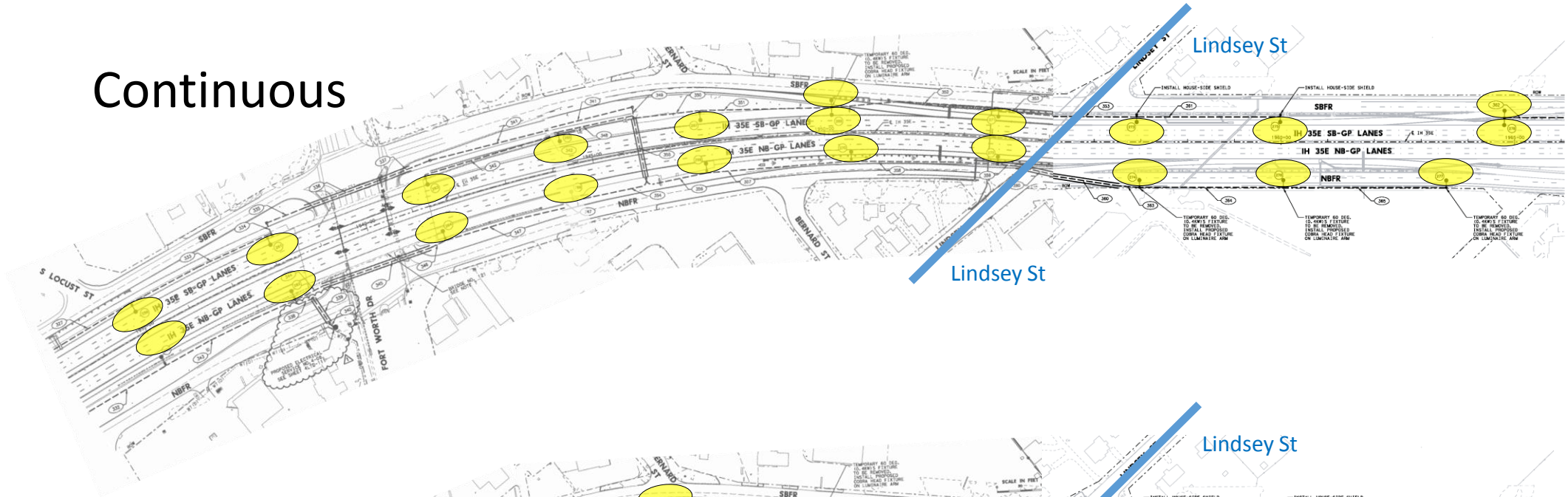

Safety

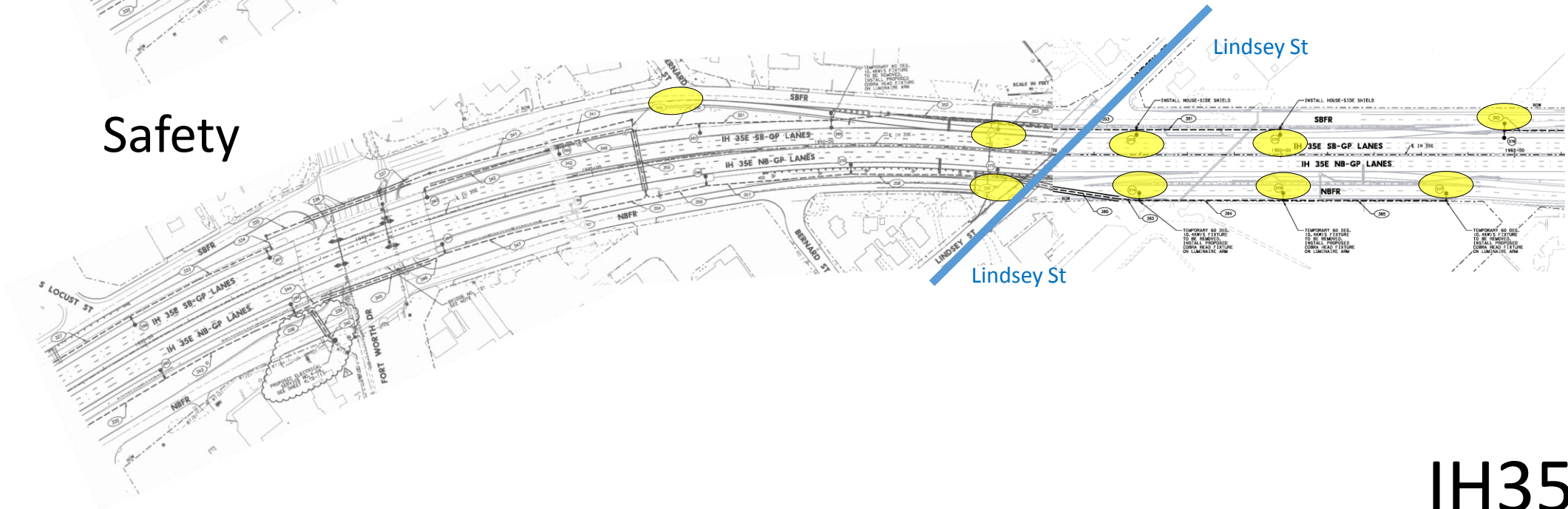

IH35 E

Continuous

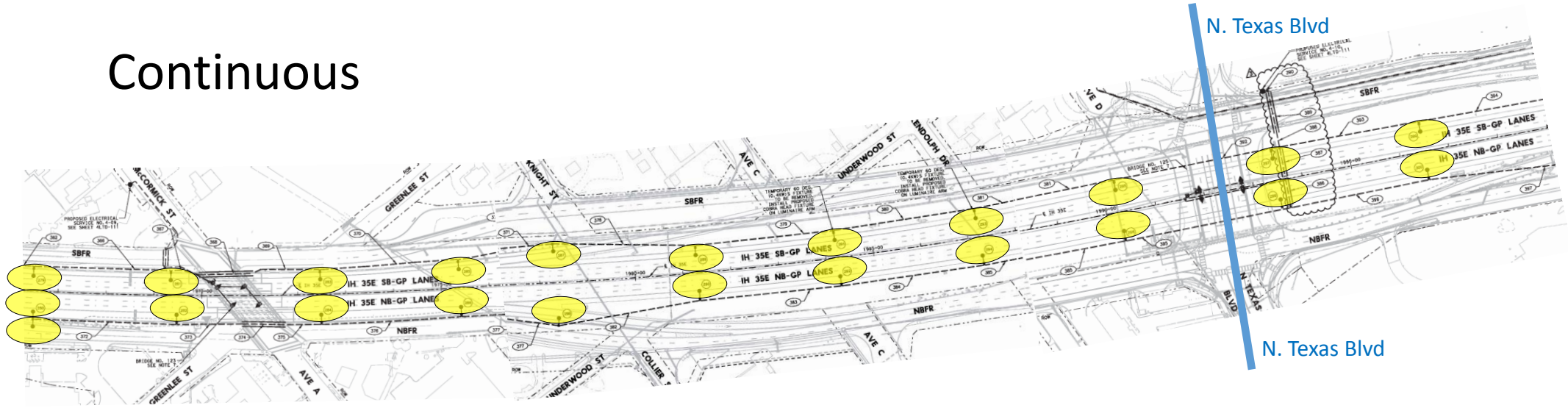

Safety

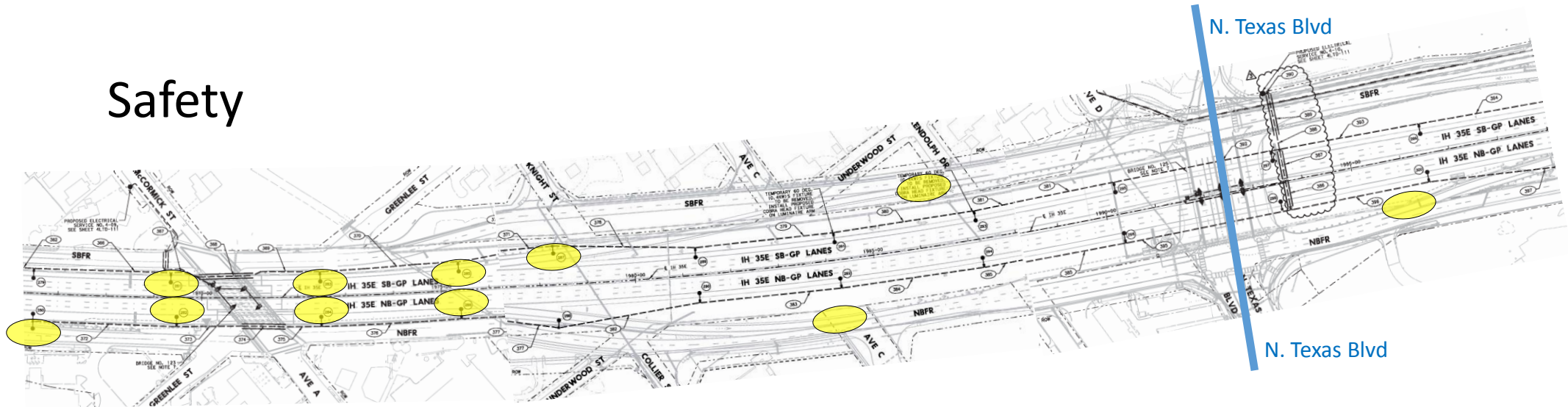

IH35 E

Continuous

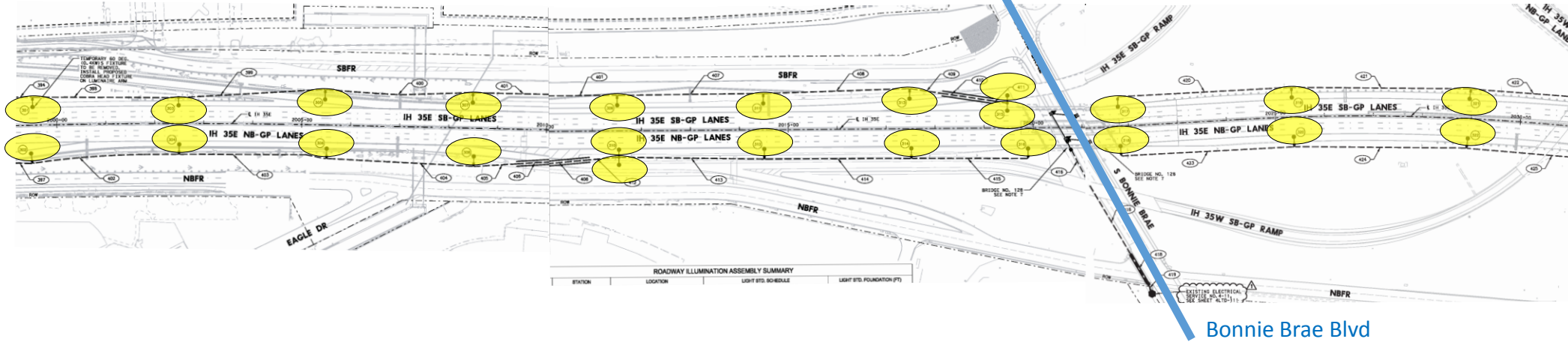

Safety

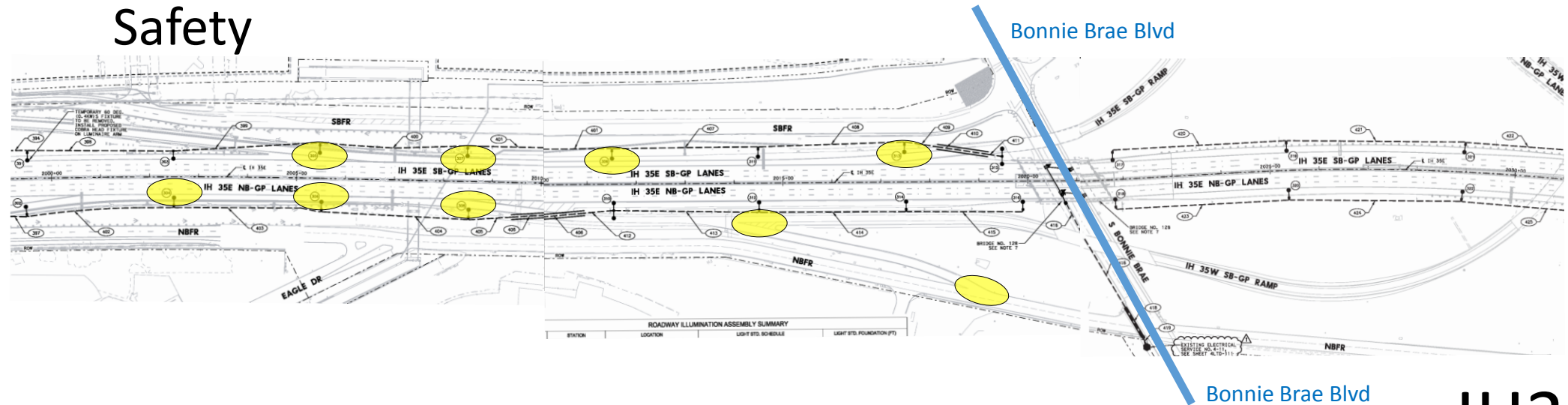

IH35 E

