



4777 EAST US HIGHWAY 80, MESQUITE, TEXAS 75150-6643 | 214-320-6100 | WWW.TXDOT.GOV

January 24, 2017

Control: 1785-01
Highway: FM 1830
County: Denton

Mr. John Davis
City Engineer
City of Denton
215 East McKinney
Denton, TX 76201

Subject: Speed Zones

Dear Mr. Davis:

Attached for your information and handling is a computer printout of the speed zone study on FM 1830 in the City of Denton. The speed study was done after the request from TXDOT, Denton County Area Office to re-evaluate the speed for the section of FM 1830 in Denton County. The printout shows that the recommended speeds correspond to the speeds at which the normal and prudent driver is driving under the existing conditions.

To proceed with the changing of the speed limits, TxDOT requires a signed city ordinance matching the zones on the speed study. To assist the City in the preparation of the ordinance, a sample speed zone ordinance has been attached to serve as a guide. Please forward the signed ordinance to our office by March 7, 2017 for further processing. Upon receipt of the ordinance from the City of Denton, TxDOT will furnish and install the necessary signs at the proper locations. Should the City already have an ordinance on file that matches the limits shown on the study, please forward a copy of that to our office for our records.

If we may be of further assistance, please feel free to contact Bahman Afsheen, P.E. at the above address or by telephone at 214-320-6229.

Sincerely,

Andrew R. Oberlander, P.E.
District Transportation Operations Engineer

Attachments

NO. _____

SPEED ZONE ORDINANCE

AN ORDINANCE ALTERING THE PRIMA FACIE SPEED LIMITS ESTABLISHED FOR VEHICLES UNDER THE PROVISIONS OF TRANSPORTATION CODE, SECTION 545.356 UPON _____ HIGHWAY NO. _____ OR PARTS THEREOF, WITHIN THE INCORPORATE LIMITS OF THE CITY OF _____, AS SET OUT IN THIS ORDINANCE; AND PROVIDING A PENALTY OF A FINE NOT TO EXCEED \$200.00 FOR THE VIOLATION OF THIS ORDINANCE.

WHEREAS, Section 545.356 of the Texas Transportation Code, provides that whenever the governing body of the City shall determine upon the basis of an engineering and traffic investigation that any prima facie speed therein set forth is greater or less than is reasonable or safe under the conditions found to exist at any intersection or other place or upon any part of a street or highway within the City, taking into consideration the width and condition of the pavement and other circumstances on such portion of said street or highway, as well as the usual traffic thereon, said governing body may determine and declare a reasonable and safe prima facie speed limit thereat or thereon by the passage of an ordinance, which shall be effective when appropriate signs giving notice thereof are erected at such intersection or other place or part of the street or highway; NOW, THEREFORE, BE IT ORDAINED BY THE CITY COUNCIL OF THE CITY OF _____, TEXAS:

SECTION 1.

Upon the basis of an engineering and traffic investigation heretofore made as authorized by the provisions of Transportation Code, Section 545.356, the following prima facie speed limits hereafter indicated for vehicles on the attached Exhibit "A" (strip map) are hereby determined and declared to be reasonable and safe; and such speed limits are hereby fixed at the rate of speed indicated for vehicles traveling upon the named streets and highways, or parts thereof, described as follows:

A. BE IT ORDAINED BY THE CITY COUNCIL OF THE CITY OF _____ TEXAS:

1. That from and after the date of the passage of this speed zone ordinance, no motor vehicle shall be operated along and upon _____ Highway No. _____ within the corporate limits of the City of _____ in excess of speeds now set forth in Exhibit "A".

SECTION 2:

The Mayor of _____ is hereby authorized to cause to be erected, appropriate signs indicating such speed zones.

SECTION 3:

Any person violating any of the provisions of this ordinance shall be deemed guilty of a misdemeanor and upon conviction thereof shall be fined in any sum not to exceed Two Hundred Dollars (\$200.00).

PASSED AND APPROVED THIS ____ DAY OF _____, A.D., 20__.

Mayor

City of _____ Texas

Attest:

City Secretary

City of _____ Texas

APPROVED AS TO LEGAL FORM:

City Attorney

City of _____ Texas

APPROVED:

City Manager

City of _____ Texas

I, _____, City Secretary of the City of _____, Texas, hereby certify that the above and foregoing is a true and correct copy of Ordinance No. _____ adopted by the City Council of the City of _____, Texas, _____, A.D., 20__.

To certify which, witness my hand and seal of office this _____ day of _____, A.D., 20__.

City Secretary

City of _____ Texas

FM 1830

DEVELOPMENT
RES. SIGHT DISTANCE
BALL BANK OR ADVISORY SPEED
CURVES OVER 2"
GRADES OVER 3%
SURFACE WIDTH AND TYPE
R.O.W. AND ROAD WIDTH
ACCIDENTS
ZONE LENGTHS (MILES)
ZONE SPEEDS (M.P.H.)



TOWARD
US 377

TOWARD
BARTONVILLE

C.L. BEARINGS

EXISTING SPEED LIMIT
ZONE SPEEDS (M.P.H.)
ZONE LENGTHS (MILES)
ACCIDENTS
R.O.W. AND ROAD WIDTH
SURFACE WIDTH AND TYPE
GRADES OVER 3%
CURVES OVER 2"
BALL BANK OR ADVISORY SPEED
RES. SIGHT DISTANCE
DEVELOPMENT

DISTRICT: DALLAS COUNTY: DENTON
HIGHWAY: FM 1830 CITY: ARGYLE
DATE OF STUDY 08-04-16 SCALE 1" = 0.1 MILES

LIMITS OF ZONE

SECTION ONE				SECTION TWO			
LENGTH 2.443 MILES				LENGTH MILES			
BEGINS	STA. OR M.P.	CONT. AND SECT.	PROJECT	BEGINS	STA. OR M.P.	CONT. AND SECT.	PROJECT
	0 - 00						
	MP 2.131				MP		
ENDS	STA. OR M.P.	CONT. AND SECT.	PROJECT	ENDS	STA. OR M.P.	CONT. AND SECT.	PROJECT
	0 - 00						
	MP 4.574				MP		

42 85 PERCENTILE SPEED
62 TOP SPEED MEASURED
125 NUMBER OF CARS CHECKED

- FATAL ACCIDENT
- PERSONAL INJURY ACCIDENT
- PROPERTY DAMAGE ACCIDENT

INDICATES SECTION ZONED BY COMMISSION MINUTE

SIGNALIZED INTERSECTION

TRIAL RUN

DENTON

000.526

000.629

WINTERCREE

BEECHWOOD

SANDERS RD
000.818

MP 000.805

MP 000.805

STATION #1A
51
58
125

MATCHLINE SHEET 2 OF 6

50
59
125

55 MPH
50 MPH
1.358

1.358
50 MPH

1 LANE

OPEN

SPEED ZONE

CONT. 1785 SEC. 01

LIMITS: BEECHWOOD TO FM 407

SHEET 1 OF 6

Texas Department of Transportation

SPEED STUDY
DENTON COUNTY
FM 1830

DESIGN TEAM	FED. RD. DIV. NO.	FEDERAL AID PROJECT NO.	SHEET NO.
	STATE	STATE DIST. NO.	COUNTY
CHECKED	CONTROL NO.	SECTION NO.	JOB NO. HIGHWAY NO.

FM 1830

DEVELOPMENT	
RES. SIGHT DISTANCE	OPEN
BALL BANK OR ADVISORY SPEED	
CURVES OVER 2°	
GRADES OVER 3%	
SURFACE WIDTH AND TYPE	1 LANE
R.O.W. AND RDBD. WIDTH	
ACCIDENTS	
ZONE LENGTHS (MILES)	1.358
ZONE SPEEDS (M.P.H.)	50 MPH

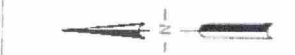

MATCHLINE SHEET 1 OF 6

001.080
W RYAN RD

DENTON

STATION #1B

51
61
125

001.737
HICKORYCRE

MATCHLINE SHEET 3 OF 6

49
56
125

EXISTING SPEED LIMIT	
ZONE SPEEDS (M.P.H.)	55 MPH
ZONE LENGTHS (MILES)	50 MPH
ACCIDENTS	1.358
R.O.W. AND RDBD. WIDTH	
SURFACE WIDTH AND TYPE	1 LANE
GRADES OVER 3%	
CURVES OVER 2°	
BALL BANK OR ADVISORY SPEED	
RES. SIGHT DISTANCE	
DEVELOPMENT	OPEN

DISTRICT: DALLAS	COUNTY: DENTON	MINUTE NO. :	DATE / /
HIGHWAY: FM 1830	CITY: ARGYLE	REPLACES :	DATE / /
DATE OF STUDY 08-04-16	SCALE 1" = 0.1 MILES	REPLACED BY :	DATE / /
		CANCELLED BY :	DATE / /

LIMITS OF ZONE			
SECTION ONE	LENGTH	MILES	
BEGINS	STA. OR M.P.	CONT. AND SECT.	PROJECT
	0 - 00	-	()
ENDS	STA. OR M.P.	CONT. AND SECT.	PROJECT
	0 - 00	-	()

42	85 PERCENTILE SPEED
62	TOP SPEED MEASURED
125	NUMBER OF CARS CHECKED

- FATAL ACCIDENT
- PERSONAL INJURY ACCIDENT
- PROPERTY DAMAGE ACCIDENT
- INDICATES SECTION ZONED BY COMMISSION MINUTE
- ▲ SIGNALIZED INTERSECTION
- ◁ TRIAL RUN

SPEED ZONE

CONT. 1785 SEC. 01
LIMITS: BEECHWOOD TO FM 407

SHEET 2 OF 6



SPEED STUDY
DENTON COUNTY
FM 1830

DESIGN TEAM	FED. RD. DIST. NO.	FEDERAL AID PROJECT NO.	SHEET NO.
	STATE	STATE DIST. NO.	COUNTY
CHECKED	CONTROL NO.	SECTION NO.	JOB NO.

FM 1830

DEVELOPMENT
RES. SIGHT DISTANCE
BALL BANK OR ADVISORY SPEED
CURVES OVER 2"
GRADES OVER 3%
SURFACE WIDTH AND TYPE
R.O.W. AND RDBD. WIDTH
ACCIDENTS
ZONE LENGTHS (MILES)
ZONE SPEEDS (M.P.H.)

RESIDENTIAL

1 LANE

2.411
50 MPH

COUNTY

STATION #5

56
62
125

MATCHLINE SHEET 4 OF 6

53
68
125

TOWARD
US 377

TOWARD
BARTONVILLE

EXISTING SPEED LIMIT
ZONE SPEEDS (M.P.H.)
ZONE LENGTHS (MILES)
ACCIDENTS
R.O.W. AND RDBD. WIDTH
SURFACE WIDTH AND TYPE
GRADES OVER 3%
CURVES OVER 2"
BALL BANK OR ADVISORY SPEED
RES. SIGHT DISTANCE
DEVELOPMENT

55 MPH
50 MPH
1.358

55 MPH
50 MPH
2.411

1 LANE

RESIDENTIAL

DISTRICT: DALLAS COUNTY: DENTON
HIGHWAY: FM 1830 CITY: ARGYLE
DATE OF STUDY 08-04-16 SCALE 1" = 0.1 MILES

MINUTE NO. : DATE / /
REPLACES : DATE / /
REPLACED BY : DATE / /
CANCELLED BY : DATE / /

42 85 PERCENTILE SPEED
62 TOP SPEED MEASURED
125 NUMBER OF CARS CHECKED

● FATAL ACCIDENT
○ PERSONAL INJURY ACCIDENT
○ PROPERTY DAMAGE ACCIDENT

— INDICATES SECTION ZONED
BY COMMISSION MINUTE

▲ SIGNALIZED INTERSECTION

○ TRIAL RUN

SPEED ZONE

CONT. 1785 SEC. 01
LIMITS: BEECHWOOD TO FM 407

SHEET 3 OF 6

Texas Department of Transportation

SPEED STUDY
DENTON COUNTY
FM 1830

DESIGN TEAM	REG. NO. DIV. NO.	FEDERAL AID PROJECT NO.	SHEET NO.
CHECKED	STATE DISC. NO.	COUNTY	
	CONTRACT NO.	SECTION NO.	JOB NO.
			HIGHWAY NO.

FM 1830

DEVELOPMENT	RESIDENTIAL	OPEN
RES. SIGHT DISTANCE		
BALL BANK OR ADVISORY SPEED		
CURVES OVER 2"		
GRADES OVER 3%		
SURFACE WIDTH AND TYPE	1 LANE	
R.O.W. AND R.O.D. WIDTH		
ACCIDENTS		
ZONE LENGTHS (MILES)	2.411	
ZONE SPEEDS (M.P.H.)	50 MPH	

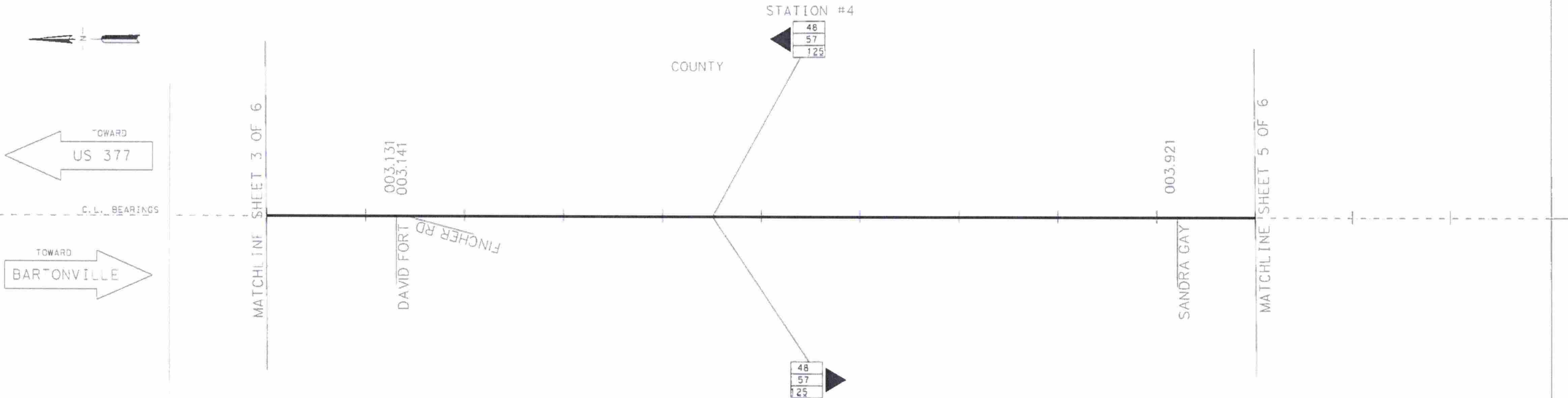

EXISTING SPEED LIMIT	55 MPH
ZONE SPEEDS (M.P.H.)	50 MPH
ZONE LENGTHS (MILES)	2.411
ACCIDENTS	
R.O.W. AND R.O.D. WIDTH	
SURFACE WIDTH AND TYPE	1 LANE
GRADES OVER 3%	
CURVES OVER 2"	
BALL BANK OR ADVISORY SPEED	
RES. SIGHT DISTANCE	
DEVELOPMENT	RESIDENTIAL

DISTRICT: DALLAS	COUNTY: DENTON	MINUTE NO. :	DATE / /
HIGHWAY: FM 1830	CITY: ARGYLE	REPLACES :	DATE / /
DATE OF STUDY 08-04-16	SCALE 1" = 0.1 MILES	REPLACED BY :	DATE / /
		CANCELLED BY :	DATE / /

LIMITS OF ZONE			
SECTION ONE	LENGTH	MILES	SECTION TWO
BEGINS	STA. OR M.P.	CONT. AND SECT.	PROJECT
	0 - 00	-	()
ENDS	STA. OR M.P.	CONT. AND SECT.	PROJECT
	0 - 00	-	()

42 85 PERCENTILE SPEED
62 TOP SPEED MEASURED
125 NUMBER OF CARS CHECKED

- FATAL ACCIDENT
- PERSONAL INJURY ACCIDENT
- PROPERTY DAMAGE ACCIDENT

— INDICATES SECTION ZONED BY COMMISSION MINUTE

▲ SIGNALIZED INTERSECTION

○ TRIAL RUN

SPEED ZONE

CONT. 1785 SEC. 01
LIMITS: BEECHWOOD TO FM 407

SHEET 4 OF 6

Texas Department of Transportation

SPEED STUDY
DENTON COUNTY
FM 1830

DESIGN TEAM	FED. RD. DIV. NO.	FEDERAL AID PROJECT NO.	SHEET NO.
	STATE	STATE DIST. NO.	COUNTY
CHECKED	CONTROL NO.	SECTION NO.	JOB NO.
			HIGHWAY NO.

FM 1830

DEVELOPMENT
RES. SIGHT DISTANCE
BALL BANK OR ADVISORY SPEED
CURVES OVER 2"
GRADES OVER 3%
SURFACE WIDTH AND TYPE
R.O.W. AND ROAD WIDTH
ACCIDENTS
ZONE LENGTHS (MILES)
ZONE SPEEDS (M.P.H.)

EXISTING SPEED LIMIT
ZONE SPEEDS (M.P.H.)
ZONE LENGTHS (MILES)
ACCIDENTS
R.O.W. AND ROAD WIDTH
SURFACE WIDTH AND TYPE
GRADES OVER 3%
CURVES OVER 2"
BALL BANK OR ADVISORY SPEED
RES. SIGHT DISTANCE
DEVELOPMENT

DISTRICT: DALLAS COUNTY: DENTON
HIGHWAY: FM 1830 CITY: ARGYLE
DATE OF STUDY 08-04-16 SCALE 1" = 0.1 MILES

SECTION ONE
LENGTH MILES
STA. OR M.P. CONT. AND SECT. PROJECT
BEGINS
ENDS

SECTION TWO
LENGTH MILES
STA. OR M.P. CONT. AND SECT. PROJECT
BEGINS
ENDS

MINUTE NO. :
REPLACES :
REPLACED BY :
CANCELLED BY :

DATE / /
DATE / /
DATE / /
DATE / /

42 85 PERCENTILE SPEED
62 TOP SPEED MEASURED
125 NUMBER OF CARS CHECKED

● FATAL ACCIDENT
○ PERSONAL INJURY ACCIDENT
○ PROPERTY DAMAGE ACCIDENT

INDICATES SECTION ZONED BY COMMISSION MINUTE
▲ SIGNALIZED INTERSECTION
○ TRIAL RUN

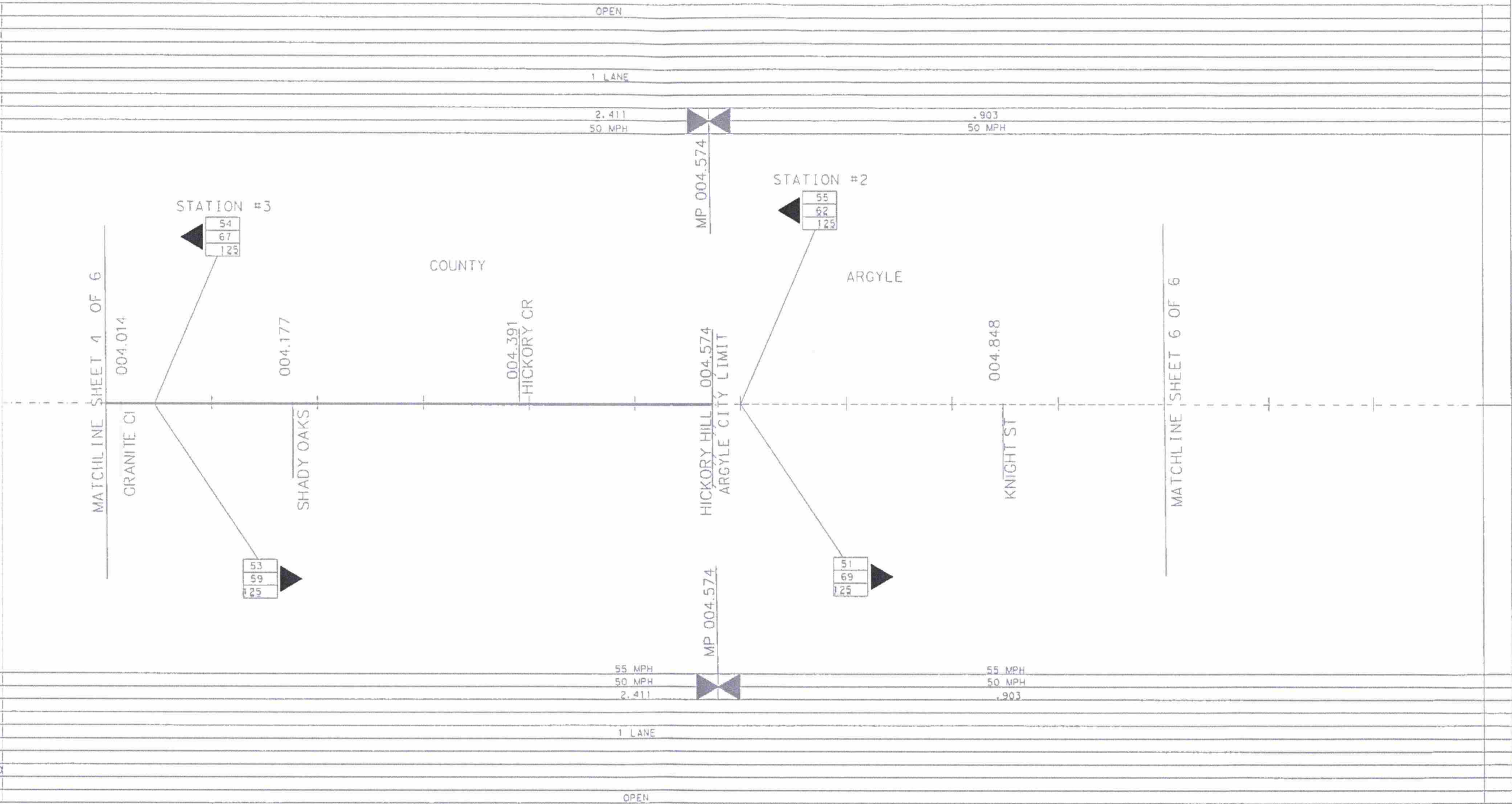

SPEED ZONE

CONT. 1785 SEC. 01
LIMITS: BEECHWOOD TO FM 407

SHEET 5 OF 6

Texas Department of Transportation			
SPEED STUDY DENTON COUNTY FM 1830			
DESIGN TEAM	FED. RD. DIV. NO.	FEDERAL AID PROJECT NO.	SHEET NO.
CHECKED	STATE	STATE DIST. NO.	COUNTY
	CONTROL NO.	SECTION NO.	JOB NO.
			HIGHWAY NO.

FM 1830

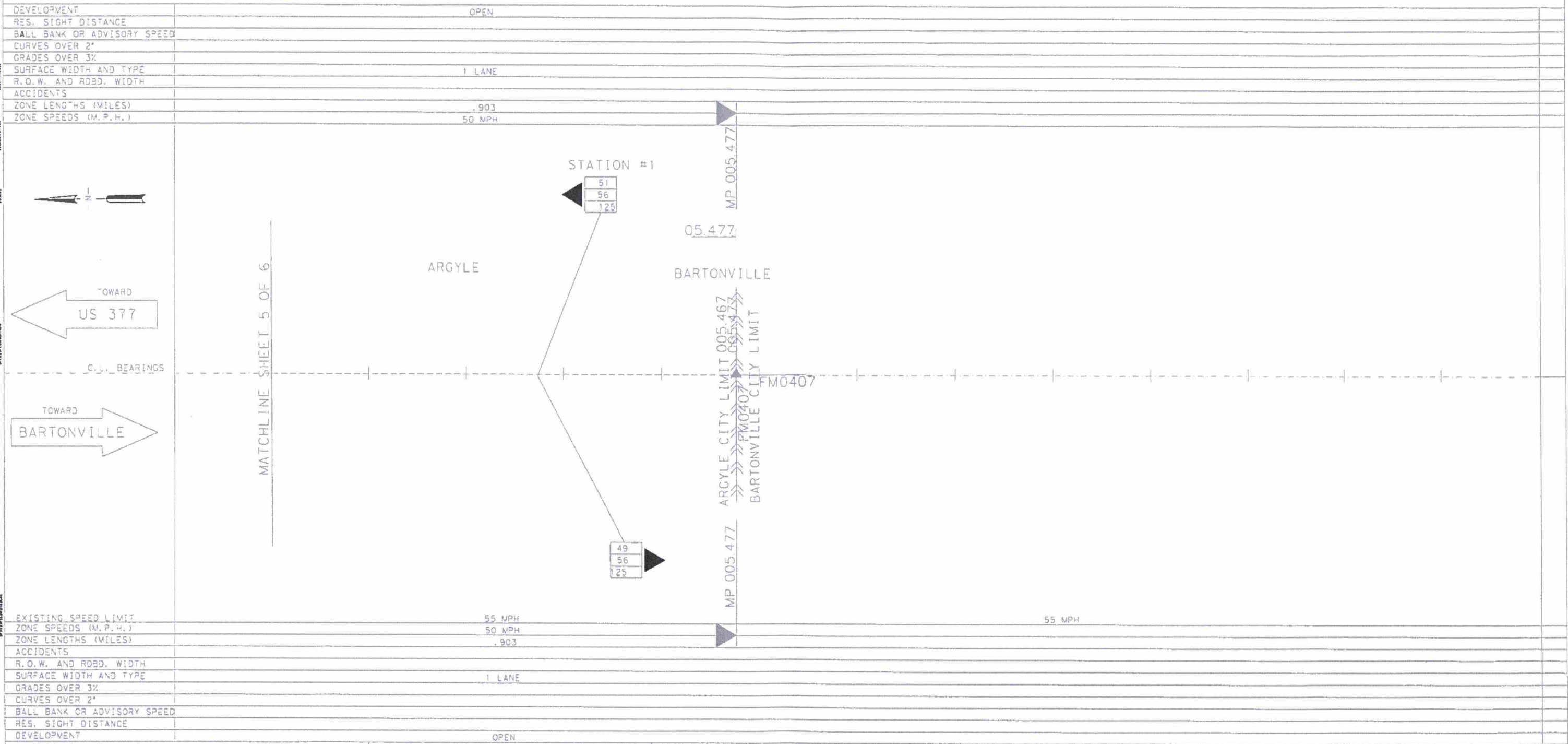

DEVELOPMENT	OPEN
RES. SIGHT DISTANCE	
BALL BANK OR ADVISORY SPEED	
CURVES OVER 2"	
GRADES OVER 3%	
SURFACE WIDTH AND TYPE	1 LANE
R.O.W. AND RDBD. WIDTH	
ACCIDENTS	
ZONE LENGTHS (MILES)	.903
ZONE SPEEDS (M.P.H.)	50 MPH

EXISTING SPEED LIMIT	
ZONE SPEEDS (M.P.H.)	55 MPH
ZONE LENGTHS (MILES)	.903
ACCIDENTS	
R.O.W. AND RDBD. WIDTH	
SURFACE WIDTH AND TYPE	1 LANE
GRADES OVER 3%	
CURVES OVER 2"	
BALL BANK OR ADVISORY SPEED	
RES. SIGHT DISTANCE	
DEVELOPMENT	OPEN

DISTRICT: DALLAS	COUNTY: DENTON	MINUTE NO. :	DATE / /
HIGHWAY: FM 1830	CITY: ARGYLE	REPLACES :	DATE / /
DATE OF STUDY 08-04-16	SCALE 1" = 0.1 MILES	REPLACED BY :	DATE / /
		CANCELLED BY :	DATE / /

LIMITS OF ZONE			
SECTION ONE	LENGTH	MILES	SECTION TWO
BEGINS	STA. OR M.P.	(CONT. AND SECT.)	PROJECT
	0 - 00	-	()
	MP		
ENDS	STA. OR M.P.	(CONT. AND SECT.)	PROJECT
	0 - 00	-	()
	MP		

42

62

125

85 PERCENTILE SPEED
TOP SPEED MEASURED
NUMBER OF CARS CHECKED

●

FATAL ACCIDENT

○

PERSONAL INJURY ACCIDENT

○

PROPERTY DAMAGE ACCIDENT

— INDICATES SECTION ZONED BY COMMISSION MINUTE

▲

SIGNALIZED INTERSECTION

○

TRIAL RUN

58

SPEED ZONE
CONT. 1785 SEC. 01
LIMITS: BEECHWOOD TO FM 407

SHEET 6 OF 6

Texas Department of Transportation

SPEED STUDY
DENTON COUNTY
FM 1830

DESIGN TEAM	FEED. NO. DIV. NO.	FEDERAL AID PROJECT NO.	SHEET NO.
	STATE	STATE DIST. NO.	COUNTY
CHECKED	CONTROL NO.	SECTION NO.	JOB NO.
			HIGHWAY NO.