

1 ORNAMENTAL METAL FENCE AND GATE
ELEVATION
SCALE: 1/2"=1'-0"

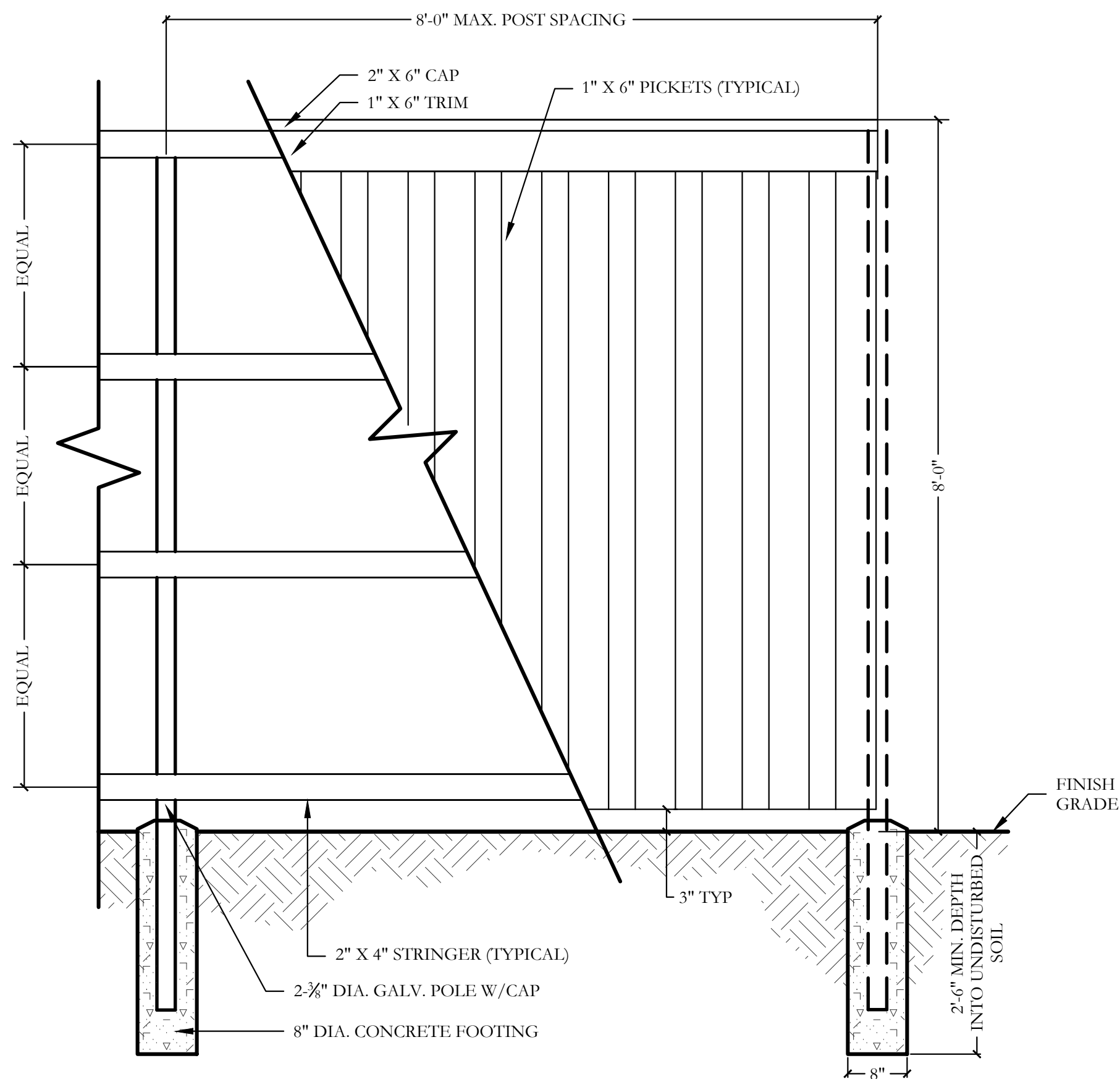

2 PARTIAL 8'-0" HT. WOOD FENCE
ELEVATION
SCALE: 3/4"=1'-0"

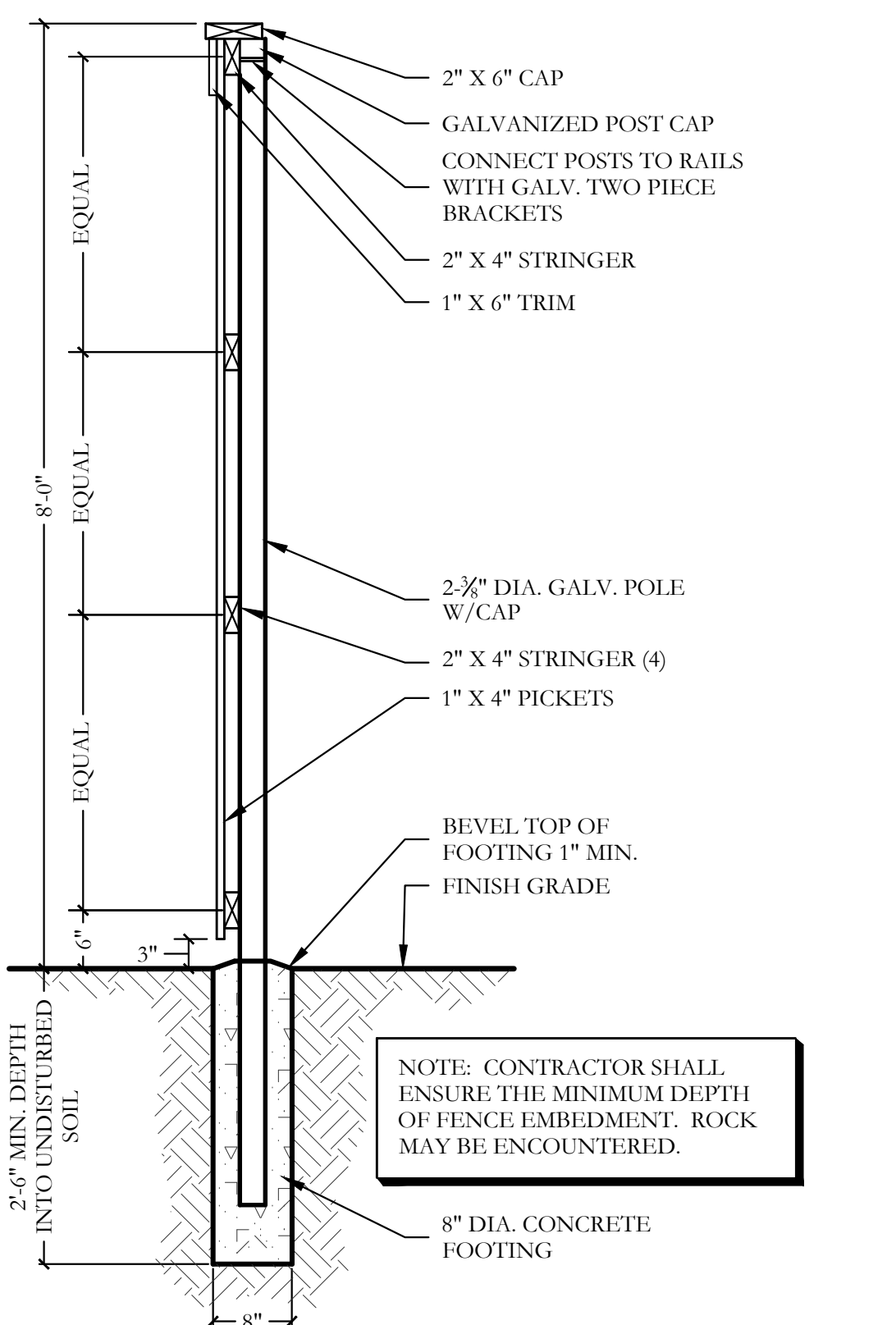

3 8'-0" HT. WOOD FENCE
SECTION
SCALE: 3/4"=1'-0"

FENCE LAYOUT NOTES

- THE CONTRACTOR IS RESPONSIBLE FOR MAKING HIMSELF FAMILIAR WITH ALL UNDERGROUND UTILITIES, PIPE AND STRUCTURES WHETHER OR NOT SHOWN ON THE PLANS. THE CONTRACTOR SHALL BE RESPONSIBLE FOR LOCATION OF ALL UNDERGROUND UTILITIES AND WILL BE RESPONSIBLE FOR COSTS INCURRED DUE TO DAMAGE OR REPLACEMENT OF SAID UTILITIES OR STRUCTURES CAUSED BY HIS FORCES. DO NOT WILLFULLY PROCEED WITH CONSTRUCTION, AS DESIGNED, WHEN IT IS OBVIOUS THAT UNKNOWN OBSTRUCTIONS OR CONFLICTS EXIST THAT MAY NOT HAVE BEEN KNOWN DURING DESIGN. SUCH CONDITIONS SHALL BE BROUGHT IMMEDIATELY TO THE ATTENTION OF THE LANDSCAPE ARCHITECT. THE CONTRACTOR SHALL ASSUME FULL RESPONSIBILITY FOR ALL NECESSARY REVISIONS DUE TO FAILURE TO GIVE SUCH NOTIFICATION.
- THE CONTRACTOR SHALL BE RESPONSIBLE FOR THE LAYOUT OF THE PROPOSED WALLS AND COLUMNS. THE OWNER'S ENGINEER SHALL STAKE THE LOCATIONS OF THE PROPERTY, R.O.W. LINES AND EASEMENTS. THE CONTRACTOR SHALL STAKE ALL OF THE FENCE AND COLUMN LOCATIONS FOR REVIEW BY THE OWNER'S REPRESENTATIVE PRIOR TO BEGINNING CONSTRUCTION. THE OWNER'S REPRESENTATIVE MAY MAKE MINOR ALTERATIONS TO THE LAYOUT AFTER STAKING AND BEFORE CONSTRUCTION AT NO ADDITIONAL COST TO THE OWNER.
- ALL "STEPS" IN THE WALL MADE NECESSARY BY GRADE CHANGES OR EXISTING SLOPE SHALL OCCUR ONLY AT MINOR OR MAJOR COLUMNS. THE MINIMUM "STEP" AT A COLUMN SHALL BE 3" AND THE MAXIMUM "STEP" AT A COLUMN SHALL BE 6".
- ALL ELECTRICAL WORK SHALL BE PERFORMED BY A LICENSED ELECTRICIAN AND SHALL BE PERFORMED IN ACCORDANCE WITH ALL APPLICABLE CODES AND REQUIREMENTS.
- THE ELECTRICAL WORK SHALL INCLUDE ALL NECESSARY CONDUITS, WIRE, FITTINGS, FIXTURES TRENCHING AND OTHER MISCELLANEOUS ITEMS NECESSARY TO COMPLETE THE WORK.
- THE CONTRACTOR SHALL BE RESPONSIBLE FOR ALL NECESSARY PERMITS AND CITY ACCEPTANCE.
- THE CONTRACTOR SHALL BE RESPONSIBLE FOR GRADING AS NEEDED FOR FENCE AND COLUMN INSTALLATION. THE CONTRACTOR SHALL RETURN THE SITE TO PRE-CONSTRUCTION CONDITION.

WOOD FENCE NOTES

- THE CONTRACTOR IS RESPONSIBLE FOR MAKING HIMSELF FAMILIAR WITH ALL UNDERGROUND UTILITIES, PIPES, AND STRUCTURES EITHER SHOWN OR NOT SHOWN ON THE PLANS. THE CONTRACTOR WILL BE RESPONSIBLE FOR ANY COST INCURRED DUE TO DAMAGE OR REPLACEMENT OF SAID UTILITIES AND STRUCTURES CAUSED BY HIS FORCES VERIFY LOCATION OF ALL UTILITIES WITH THE TOWN AND VARIOUS UTILITY COMPANIES BEFORE DRILLING PIERS.
- ALL CONCRETE USED IN FOOTINGS SHALL HAVE A MINIMUM COMPRESSIVE STRENGTH OF 3,000 PSI @ 28 DAYS.
- THE CONTRACTOR IS RESPONSIBLE FOR ALL NECESSARY AND REQUIRED PERMITS AND INSPECTIONS. CONSTRUCTION SHALL BE IN ACCORDANCE WITH CITY OF DENTON CODES AND REQUIREMENTS.
- WOOD MATERIAL FOR FENCE:
 - STRINGERS- CEDAR, #2 GRADE OR BETTER.
 - PICKETS- CEDAR, #2 GRADE OR BETTER.
 - CAPS- CEDAR, #2 GRADE OR, BETTER.
- ALL FENCE POST TO BE SCHEDULE 40 - GALVANIZED.
- ALL FASTENERS, NAILS, BRACKETS, STEEL POSTS, ETC. ARE TO BE HOT DIPPED GALVANIZED.
- ALL PICKETS ARE TO BE FASTENED TO THE RAILS USING GALVANIZED SCREWS, STAPLES AND/OR NAILS WILL NOT BE ALLOWED. SCREW WITHOUT SPLITTING MEMBERS; DRILL PILOT HOLES IF NECESSARY. ALL SPLIT MEMBERS WILL BE REQUIRED TO BE REPLACED AT NO ADDITIONAL COST TO THE OWNER.
- ACCURATELY CUT, FIT FASTEN MEMBERS, MAKE PLUMB, LEVEL, TRUE, AND RIGID. DO NOT SPLICE INDIVIDUAL FRAMING MEMBERS BETWEEN SUPPORTS. ERECT FACES OF FRAMING MEMBERS IN STRAIGHT EVEN PLANES TO RECEIVE FINISH MATERIALS. INSTALL STRINGERS WITH BOTTOM EDGES FREE OF DEFECTS. MITER ALL EXPOSED FINISHED JOINTS.
- REMOVE ALL MARKS, STAMPS, DIRT, LOOSE FIBERS FROM ALL WOOD SURFACES.
- CONTRACTOR IS RESPONSIBLE FOR OBTAINING ALL REQUIRED PERMITS.

ORNAMENTAL METAL FENCE NOTES

- THE CONTRACTOR IS RESPONSIBLE FOR MAKING HIMSELF FAMILIAR WITH ALL UNDERGROUND UTILITIES, PIPES, AND STRUCTURES EITHER SHOWN OR NOT SHOWN ON THE PLANS. THE CONTRACTOR WILL BE RESPONSIBLE FOR ANY COST INCURRED DUE TO DAMAGE OR REPLACEMENT OF SAID UTILITIES AND STRUCTURES CAUSED BY HIS FORCES.
- ALL CONCRETE USED IN FOOTING AND PIERS SHALL HAVE A MINIMUM COMPRESSIVE STRENGTH OF 3000 PSI @ 28 DAYS.
- THE CONTRACTOR IS RESPONSIBLE FOR ALL REQUIRED PERMITS AND CITY INSPECTIONS.
- ALL ORNAMENTAL METAL TUBES, POSTS, RAILS AND PICKETS SHALL BE FLUSH AND FREE OF ALL DENTS, SPURS, AND SHARP EDGES AND SHALL BE INSTALLED LEVEL, PLUMB, AND SQUARE.
- PROVIDE CONTINUOUS WELDS ALONG ALL EDGES OF FENCE MEMBERS. GRIND SMOOTH ALL WELDS.
- ALL METAL SURFACES SHALL BE PRIMED AND PAINTED WITH TWO COATS OF URBANE BRONZE (SW7048) BY SHERWIN WILLIAMS PAINT CO., COLOR TO BE FLAT BLACK. CONTRACTOR TO SUBMIT SAMPLES AS REQUIRED.
- CONTRACTOR IS RESPONSIBLE FOR VERIFYING ALL DIMENSIONS BEFORE MANUFACTURING GATES AND FENCE.
- ALL ORNAMENTAL METAL FENCE MEMBERS ARE TO BE TUBULAR MEMBERS IN ACCORDANCE WITH ASTM 513 HOT ROLLED STRUCTURAL STEEL 50,000 PSI TENSILE STRENGTH, 60,000 PSI YIELD STRENGTH.
- FENCE MEMBER SIZES TO BE AS FOLLOWS:
 - PICKETS, 3/4" SQUARE 16 GA.
 - RAILS, 2" X 2" SOLID FLAT 16 GA.
- POSTS, 2" SQUARE 11 GA.
- CONTRACTOR TO PROVIDE SHOP DRAWINGS FOR ALL FENCE GATES AND OPENERS. SHOP DRAWINGS SHALL INCLUDE ALL PRODUCT CUT SHEETS AS WELL AS INSTALLATION AND MANUFACTURING DETAILS. CONTRACTOR TO BE RESPONSIBLE FOR STRUCTURAL DESIGN OF GATES.
- CONCRETE FOOTING FOR POSTS SHALL BE 3X POST WIDTH. GATE IS TO BE SELF CLOSING. FALCON B561BD626 SATIN CHROME DANE SFG CLASSROOM LOCK BY A&H TURE. DEADLOCKING LATCH BOLT BY LEVERS. OUTSIDE LEVER IS LOCKED BY KEY IN OUTSIDE LEVER. INSIDE LEVER IS ALWAYS FREE.
- POSTS SHALL BE PLACED AT A MINIMUM DISTANCE OF 6'-0" O.C. AND A MAXIMUM DISTANCE OF 7'-0" O.C.
- POOL FENCE SHALL MEET LOCAL CODES AND REQUIREMENTS. CONTRACTOR SHALL BE RESPONSIBLE FOR ENSURING COMPLIANCE INCLUDING NECESSARY UPSIZING OF POSTS, PICKETS AND HORIZONTAL BARS AND INCREASING THE HEIGHT OF THE FENCE AS IT APPEARS IN THIS DETAIL AT NO ADDITIONAL COST TO THE OWNER FOR MATERIALS AND/OR LABOR.
- LATCH SHALL BE SELF LATCHING, ON POOL SIDE OF ENCLOSURE AT A MIN. 42" ABOVE FINISH PAVING.
- RESTRICTIVE MESH SHALL HAVE NO OPENINGS GREATER THAN 1/2" AND SHALL.



211 North Lindbergh Blvd.
St. Louis, MO 63141
800.231.1327 tel | 314.754.0835 fax
specify@anovafurnishings.com
anovafurnishings.com

AL19BR2— Allure Bike Rack, 2-bike capacity

Cast aluminum bike rack, surface mount

Material

The bike rack is composed of corrosion-resistant cast aluminum. Use as a stand-alone or arrange in groups. A standard U-lock can be used to meet Association of Pedestrian and Bicycle Professionals (APBP) guidelines for security and functionality. Aluminum is 100% recyclable.

The base has predrilled 4" diameter holes for surface mounting to prevent movement.

Surface mounting is required; mounting hardware is not included.

Finish

Face-resistant, powder coated cast aluminum components feature a state-of-the-art primer proven to prevent rusting. Treated components exceed the industry standard by 34% in testing by independent sources.

Color

See website or sales representative for color choices.

Assembly

The bike rack ships fully assembled and ready for use. Surface mounting will require some assembly.

Maintenance

The product is virtually maintenance-free and requires only periodic cleaning with a sponge and a solution of mild detergent and water to remove surface dirt. Do not clean with solvent or petroleum base products.

Warranty

20-year limited structural warranty with 7-year finish warranty against fading from the date of purchase. See full details on multi-year warranties for components at www.anovafurnishings.com/warranty.aspx.

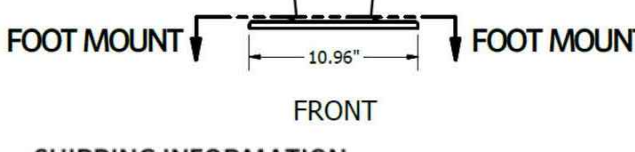
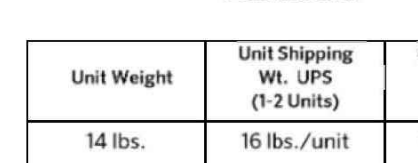
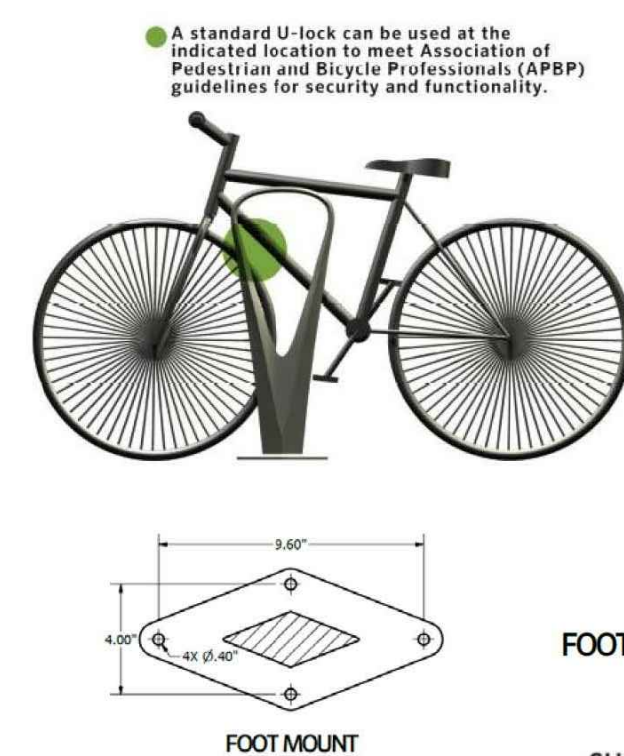

SHIPPING INFORMATION

Unit Weight	Unit Shipping Wt. (UPS)	Unit Shipping Wt. (Truck)	Unit Ship Size w/Pallet	Max Units Per Pallet	Pallet Size/Wt. (32" x 48")	Total No. Pkgs.	Shipping Class
14 lbs.	16 lbs./unit	16 lbs./unit	9.56 cu. ft.	16	50 lbs.	1	125

11/24/2015 Copyright 2016 ANOVA® Made in U.S.A.

4 BIKE RACK
MANUFACTURER SPECIFICATION SHEET
NTS

CODY JOHNSON
s . t . u . d . i . o



Bar is one inch on original drawing. If not one inch on this sheet, adjust scale as necessary.
One Inch

AMENITY CENTER FACILITY

Site Details

Country Lakes North - Phase 3A-B Amenity Center

City of Denton, Denton County, Texas

CJS PROJECT NO.

VIN003

SHEET NO.

L5

PDA16-0004

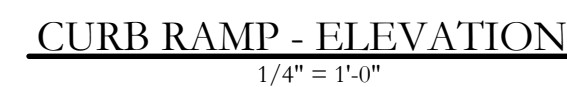

- PLAYGROUND NOTES:
1. PLAYGROUND SURFACE TO BE APPROVED ENGINEERED HARDWOOD FIBER CHIPS.
 2. 1/2" REDWOOD EXPANSION JOINTS SHALL BE PROVIDED WHERE SHOWN ON THE PLAN. EXPANSION JOINTS SHALL BE CONTINUOUS THROUGH THE WALK AND CONCRETE EDGE WHERE ADJACENT. INSTALL VERTICAL EXPANSION JOINTS IN PLAYGROUND EDGE ON MAXIMUM 30 FOOT CENTERS.
 3. CONTRACTOR TO EXCAVATE FULL DEPTH OF PLAYGROUND BORDER WHERE SHOWN AS AREA TO BE EXCAVATED.
 4. ALIGN RAMP WITH TRANSFER STATION OF PLAYGROUND EQUIPMENT

HEIGHT (H)	1'	2'	3'
BASE DEPTH (A)	6"	6"	12"
BASE WIDTH (B)	14"	16"	18"
CAP DEPTH (C)	FULL	FULL	FULL
GRAVEL DEPTH	N/A	N/A	N/A
BATTER	2"	4"	6"

- GENERAL NOTES:
1. NO STRUCTURAL SURCHARGE ANTICIPATED FOR STRUCTURES LOCATED DISTANCE EQUAL TO 1.5H FROM WALL.
 2. TYPE S MORTAR REQUIRED.
 3. CONTROL JOINTS AT 25' MAXIMUM SPACING.
 4. INSTALL 2" PVC WEEP HOLES FOR ALL WALLS 2'-0" HEIGHT AND OVER AT 6'-0" O.C. SPACING.
 5. MINIMUM 2% AND MAXIMUM 4:1 TOE SLOPE AT FINISH GRADE.
 6. MAXIMUM RETAINING WALL HEIGHT SHALL BE 3'-0".

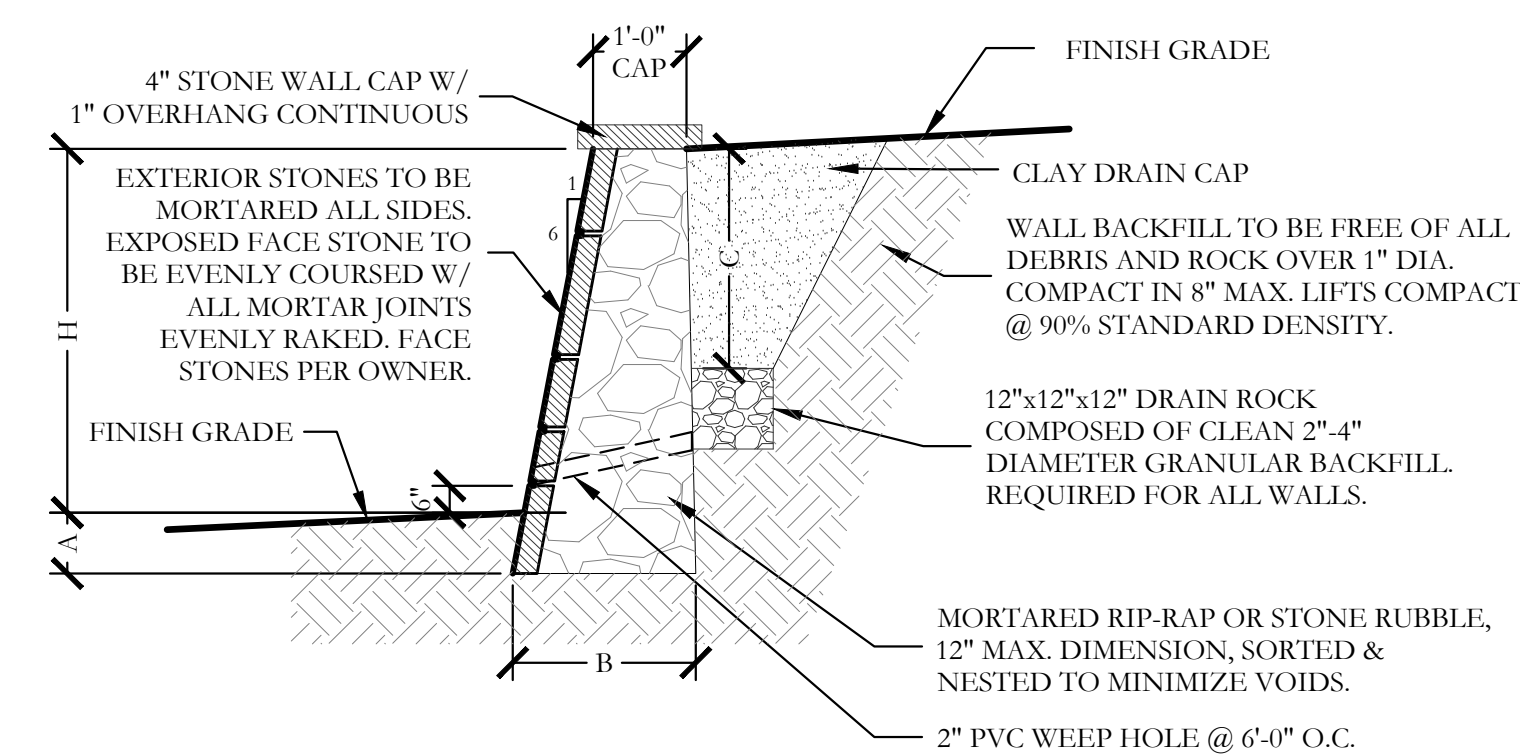

SCALE AS SHOWN

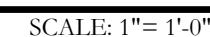

<u>ITEM</u>	<u>QTY</u>	<u>MANUFACTURER</u>	<u>MODEL</u>
FEATURE PLAYGROUND SET	1	MIRACLE RECREATION	4717285972A
ARCH SWING SET	1	MIRACLE RECREATION	7188522S

PRODUCT REPRESENTATIVE:
FOR ALL PRODUCTS SPECIFIED WITHIN THE EQUIPMENT SCHEDULE AND SHOWN ON PLANS,
CONTACT TOM SAWYERS FOR PRICING AND INSTALLATION GUIDANCE.

THOMAS SAWYERS, CPSI
EMAIL: TSAWYERS@WEBBUILDFUN.COM
PHONE: 972-727-0653

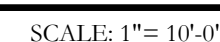

June 22, 2016



REAVES CONSULTING
831 ARROWHEAD DRIVE
PROSPER, TEXAS 75078
972.347.3908
RICHARD@REAVESCONSULTINGLLC.COM
F-10826

Bar is one inch on original drawing. If not one inch on this sheet, adjust scale as necessary.

One Inch

AMENITY CENTER FACILITY

Site Details

Country Lakes North - Phase 3A-B Amenity Center

City of Denton, Denton County, Texas

CJS PROJECT NO.

VIN003

SHEET NO.

L6

PDA16-0004



NTS



NTS



NTS

[illegible]

NTS

SCALE: 1/4" = 1'-0"

SCALE: 1/4" = 1'-0"

SCALE: 1/2" = 1'-0"

1. THE CONTRACTOR IS RESPONSIBLE FOR MAKING HIMSELF FAMILIAR WITH ALL UNDERGROUND UTILITIES, PIPES, AND STRUCTURES EITHER SHOWN OR NOT SHOWN ON THE PLANS. THE CONTRACTOR WILL BE RESPONSIBLE FOR ANY COST INCURRED DUE TO DAMAGE OR REPLACEMENT OF SAID UTILITIES AND STRUCTURES CAUSED BY HIS FORCES. VERIFY LOCATION OF ALL UTILITIES WITH THE CITY AND VARIOUS UTILITY COMPANIES BEFORE DRILLING PIERS.
2. ALL CONCRETE USED IN FOOTINGS SHALL HAVE A MINIMUM COMPRESSIVE STRENGTH OF 3,000 PSI @ 28 DAYS.
3. THE CONTRACTOR IS RESPONSIBLE FOR ALL NECESSARY AND REQUIRED PERMITS AND INSPECTIONS. ALL CONSTRUCTION SHALL BE IN ACCORDANCE WITH CITY OF FRISCO CODES AND REQUIREMENTS.
4. WOOD MATERIAL FOR FENCE
 - 4.1. JOIST- CEDAR, #2 GRADE OR BETTER.
 - 4.2. BEAM- CEDAR, #2 GRADE OR BETTER.
 - 4.3. POST- CEDAR, #2 GRADE OR, BETTER
5. ALL FASTENERS, NAILS, BRACKETS, STEEL POSTS, ETC. ARE TO BE HOT DIPPED GALVANIZED.
6. ACCURATELY CUT, FIT FASTEN MEMBERS, MAKE PLUMB, LEVEL, TRUE, AND RIGID. DO NOT SPICE INDIVIDUAL FRAMING MEMBERS BETWEEN SUPPORTS. ERCT FACES OF FRAMING MEMBERS IN STRAIGHT EVEN PLANE. REMOVE FINISH MATERIAL. REMOVE ALL MARKS, STAMPS, DIRT, LOOSE FIBERS FROM ALL WOOD SURFACES.
7. CONTRACTOR IS RESPONSIBLE FOR OBTAINING ALL REQUIRED PERMITS.

June 22, 2016

Bar is one inch on original drawing. If not one inch on this sheet, adjust scale as necessary.

One Inch

Site Details

Country Lakes North - Phase 3A-B Amenity Center

City of Denton, Denton County, Texas

C.I.S. PROJECT NO.

VIN003

SHEET NO.

L7

PD A16-0004