

# LIBRADA “LILY” CANTÚ PLAYGROUND

PARKS BOARD MEETING

APRIL 1, 2024

MESA



PRB24-013

4/1/2024



# MEETING AGENDA

1. Team Introduction
2. Community Engagement
3. About Librada “Lily” Cantu
4. Design Consultant Introduction
5. Defining an Inclusive Playground
6. Project Location
7. Site Analysis
8. Project Goals and Concept
9. Master Plan and Inspirational Imagery
10. Upcoming Schedule



# PROJECT TEAM

## *PARKS & RECREATION STAFF*



## *DESIGN CONSULTANT*



MESA Design Group

in consultation with

*STAR Institute for Sensory Processing*

## *CANTÚ FAMILY (SIBLINGS)*

## *FOCUS GROUP*

- Denton County MHMR
- UNT
- TWU
- Denton ISD
- Lewisville ISD
- Lake Dallas DISD
- Cook's Children
- Texas Health
- United Way
- Denton Park & Beautification Board Member
- Denton Committee on Persons with Disabilities Board Member
- Occupational & Recreational Therapists

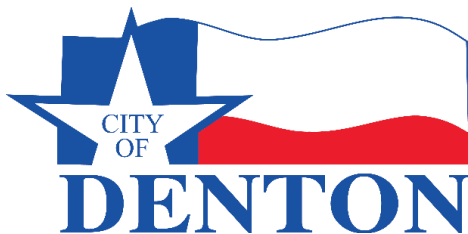



# COMMUNITY ENGAGEMENT

JANUARY 2022	PARKS, RECREATION, and TRAILS SYSTEM MASTER PLAN ADOPTED
OCTOBER 2022	PARKS RECEIVE FUNDING TO HIRE DESIGN CONSULTANT
SPRING 2023	DESIGN CONSULTANT HIRED
NOVEMBER 2023	2023 BOND PROGRAM PROPOSITION C PASSED ISSUED \$3.45M TOWARDS CONSTRUCTION OF PROJECT

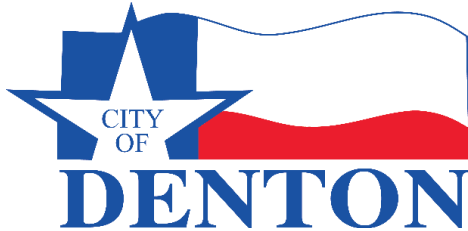



# PLAYGROUND NAMESAKE

## ABOUT LIBRADA “LILY” ROSE CANTÚ

- Renaming of the playground at North Lakes Park was adopted by City Council in 2022
- Lily grew up in Denton and spent much time at North Lakes Park Playground with her family
- Lily developed a passion for helping children from all backgrounds which led her to volunteer at a home for medically fragile children in Peru
- Lily is remembered by family members as someone with humility, an open mind, and always willing to help

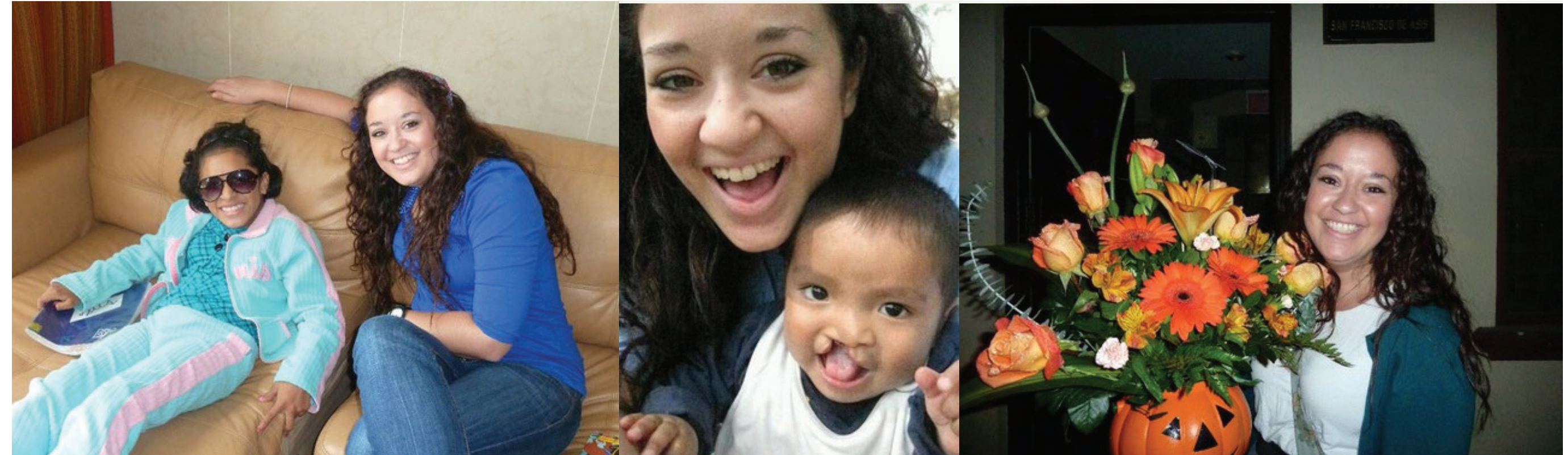

*“Lily always walked with bravery and kindness” - Marian Cantú*

## FAMILY ENGAGEMENT

In Summer 2023, MESA Design Group and Parks & Recreation met with the Cantú family to learn more about Lily’s story and discuss opportunities to honor her legacy with the playground redesign.

In Winter 2024, based on feedback received from the Cantú family, MESA Design Group and Parks & Recreation met with the family to introduce conceptual illustrations and receive feedback on the conceptual design.

*Ultimately, the family supported and felt the theme included in this presentation represented Lily the best.*

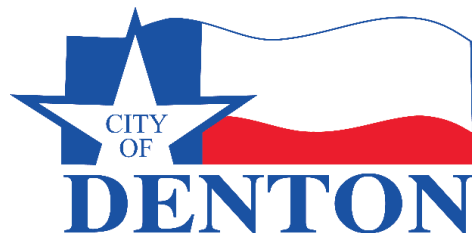

LIBRADA “LILY” CANTÚ PLAYGROUND

PRB24-013

APRIL 1, 2024 | PROJECT #: 22283

4/1/2024

MESA





# ABOUT MESA

- Landscape Architecture, Planning, and Urban Design
- Established 1981
- Office located in Dallas' Historic West End District
- Principals with 20 - 30 years experience directly involved in design process
- Staff of 25 Professionals



The Star Institute for Sensory Processing will provide consulting services during the Design Development phase.

The Star Institute was formed in 2016 to provide treatment, education, and research for children, adolescents, and adults with sensory processing disorder.

---

## *WORK EXPERIENCE WITHIN DENTON*

- North Lakes Park Master Plan (2000)
- Cross Timbers Park Master Plan (1999)
- UNT Library Mall (2004)
- Rayzor Ranch (2006)
- Lantana Community (Denton County, 2000)
- Ryan Ranch Community (1999)

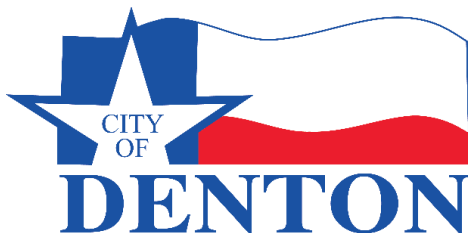

LIBRADA "LILY" CANTÚ PLAYGROUND

PRB24-013

APRIL 1, 2024 | PROJECT #: 22283

4/1/2024

MESA



# WHAT IS AN INCLUSIVE PLAYGROUND?

**A UNIVERSALLY DESIGNED, SENSORY-RICH ENVIRONMENT THAT ENABLES ALL INDIVIDUALS TO DEVELOP PHYSICALLY, SOCIALLY, AND EMOTIONALLY IN THE SAME SPACE.**

By law, all playgrounds must be ADA compliant, but they are all not necessarily inclusive. An inclusive playground takes into account physical, intellectual, and sensory disabilities.

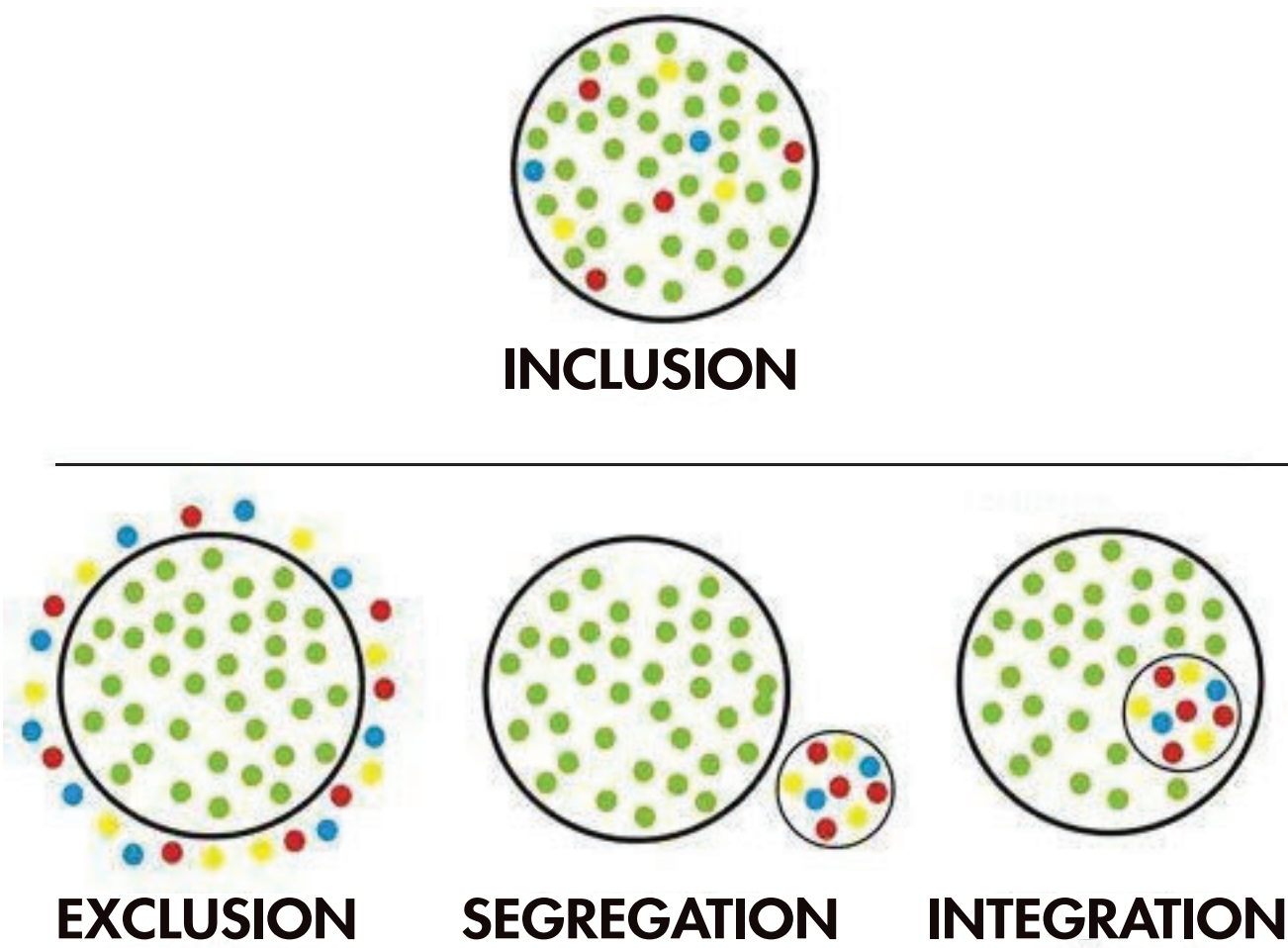

**1 in 6 children** have one or more developmental disabilities (CDC)

**1 in 4 adults** live with a disability (CDC)

**92%** of disabilities are not visible (CDC)



PROJECT LOCATION  
NORTH LAKES PARK

LEGEND

- CITY PARKS**  
Larger parks that draws residents from across the city and is often used to host citywide events. 300-500 acres in size. Service area 0-10 miles.
- COMMUNITY PARKS**  
Larger park that serves multiple surrounding neighborhoods 20-50 acres in size. Service area 0-5 miles.
- NEIGHBORHOOD PARKS**  
Small to medium sized parks within walking distance of the immediate service population. 3-20 acres in size. Service area 0-1 miles.
- POCKET PARKS**  
Small park accessible to the public that often fills gaps in park coverage. 0-3 acres in size. Service area 0-0.5 miles.
- PRESERVE**  
Protected area of land with varying size. Service area is city wide.
- LINEAR PARKS**  
A greenway or stretch of open space that can vary in size but is typically longer than wide. Service area is city wide.
- SPECIAL USE PARKS**  
Has a dedicated or unique use with varying size. Service area is city wide.
- CEMETERY**

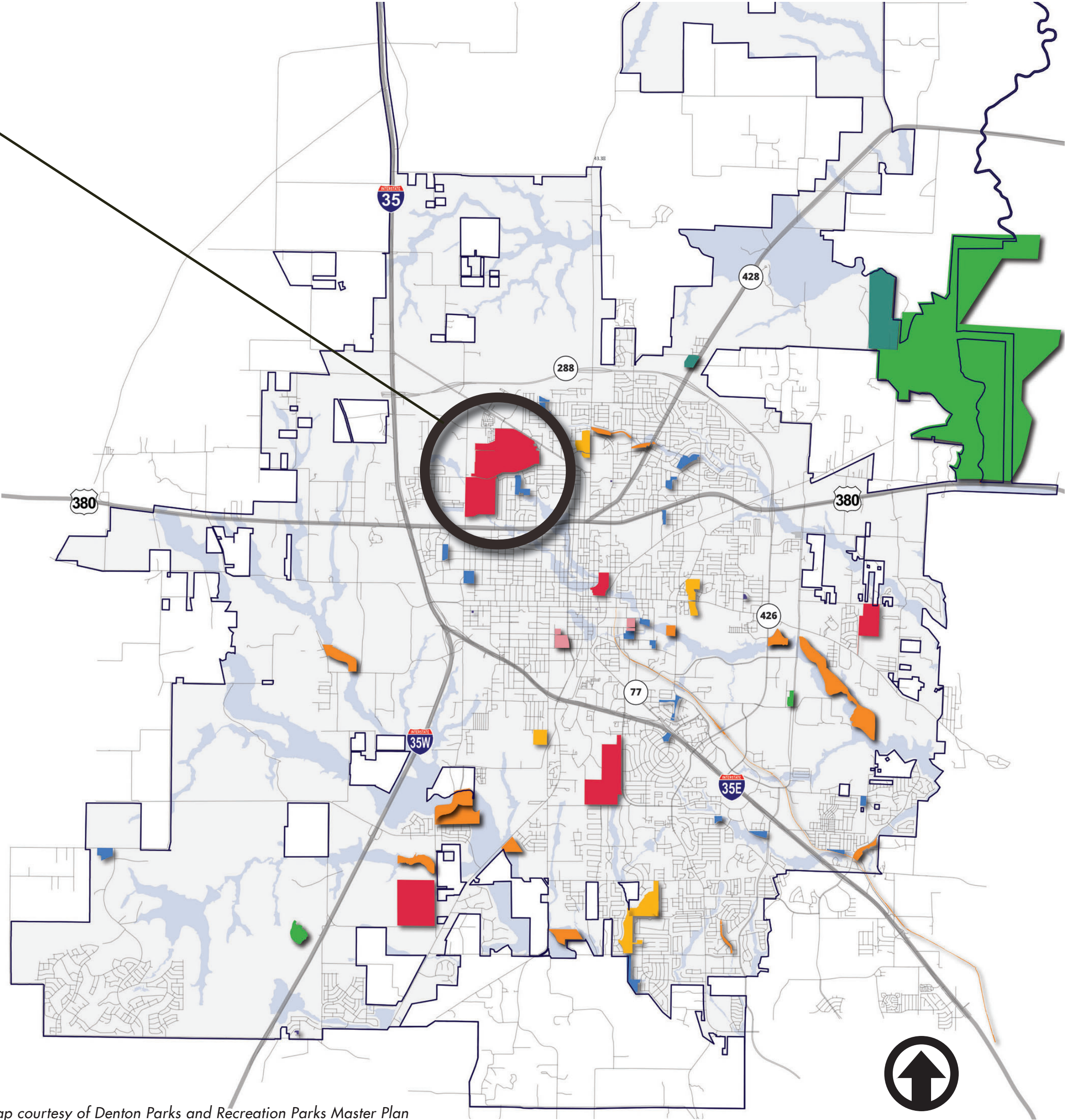

Map courtesy of Denton Parks and Recreation Parks Master Plan

PROJECT LOCATION

LIBRADA "LILY" CANTÚ PLAYGROUND



EXISTING 5-12 AGE ZONE CONDITIONS



EXISTING 2-5 AGE ZONE CONDITIONS WITH MAIN PAVILION BEYOND



EXISTING PARKING LOT CONDITIONS



APRIL 1, 2024 | PROJECT #: 22283

PRB24-013

4/1/2024

MESA



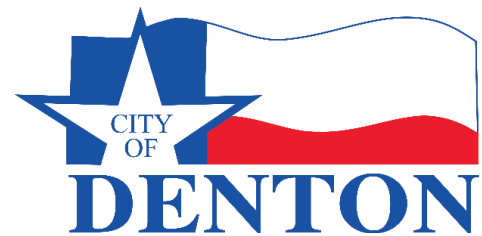

# EXISTING CONDITIONS ACCESSIBILITY ASSESSMENT

LIBRADA "LILY" CANTÚ PLAYGROUND

PRB24-013

APRIL 1, 2024 | PROJECT #: 22283

4/1/2024

MESA



# PROJECT GOALS

1. Design for a *wide range of ages and abilities* allowing all visitors to participate in play
2. Incorporate *sensory-rich* play elements while remaining mindful of potentially overstimulating stimuli
3. Provide close proximity to *comforts and conveniences* (ie. shade, bathrooms, drinking fountains)
4. Provide *sufficient accessible parking and pathway circulation*
5. *Engage local resources* to inform playground design decisions
6. Design with *project phasing* in mind
7. Craft a plan for adequate *site maintenance* and staffing

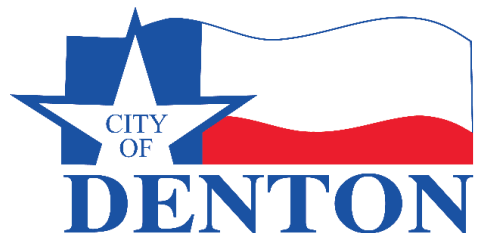

**PROJECT GOALS**  
LIBRADA "LILY" CANTÚ PLAYGROUND

PRB24-013

APRIL 1, 2024 | PROJECT #: 22283  
4/1/2024

MESA



# MULTI-SENSORY PLAY

GOAL: PROVIDE COMFORTABLE AND SUPPORTIVE SENSORY STIMULATION THROUGH THE NATURAL ENVIRONMENT FOR THE FACILITATION OF SELF-REGULATION AND SOCIAL PARTICIPATION.

## NEAR SENSES

- OPERATE WITHOUT CONSCIOUS THOUGHT -

- VESTIBULAR INPUT  
SENSE OF POSITION AND MOVEMENT
- PROPRIOCEPTIVE INPUT  
JOINT AND MUSCLE SENSE
- INTEROCEPTION INPUT  
SENSE OF INTERNAL ORGANS

## FAR SENSES

- RESPOND TO EXTERNAL STIMULI FROM THE ENVIRONMENT -

- AUDITORY
- VISUAL
- TACTILE
- SMELL
- TASTE

## SENSORY INTEGRATION

MANIPULATION OF INPUT INFORMATION FOR AN OUTPUT RESPONSE TO THE ENVIRONMENT

## DEVELOPMENTAL PLAY

- ENCOURAGEMENT OF SKILL BUILDING -

- MOTOR PLANNING  
· ALLOWS CHILDREN TO CONCEIVE, ORGANIZE, AND CARRY OUT UNFAMILIAR SEQUENCES OF MOVEMENT IN A COORDINATED MANNER.
- SOCIAL & COOPERATIVE PLAY  
· OPPORTUNITIES FOR IMAGINATIVE PLAY, TAKING TURNS, AND CONVERSATION ARE VITAL TO A CHILD'S DEVELOPMENT, AS WELL AS ASSISTING THEM IN NURTURING THEIR RELATIONSHIPS WITH OTHERS.

### DESCRIPTION:

Sensory Processing Disorder (SPD) is a framework first described by occupational therapist A. Jean Ayres, PhD, in the 1970's. It is a term that refers to the way the nervous system receives messages from the senses and turns them into appropriate motor and behavioral responses.

Clinical studies of children *without* various disabilities have estimated SPD affects between 5% and 10% of children. However, for children with various disabilities, estimated rates of those affected by SPD have been reported to be as high as 40% to 88%. (Ahn, Miller, Milberger, McIntosh, American Journal of Occupational Therapy, 2004).

Many children with autism also have some form of SPD. This is most often reflected in the hypo- or hyper-sensitivity to sensory stimuli including sound, sight, smells, tastes, and textures. This sensitivity to the senses, coupled with the inability to filter input from additional external stimuli, can become overwhelming and lead to tantrums and melt-downs. (Sachs, Vincenta, Implications, 2011).

In addition to the five far senses (auditory, visual, tactile, smell, and taste), Dr. Ayres identified three other senses commonly referred to as near senses. These internal senses include Vestibular, Proprioception, and Interoception and unlike the far senses, operate without conscious thought and can not be observed.

Consideration for sensory stimulation in playground design is imperative to developmental play and skill building in children. Through thoughtful sensory stimulation, nature-based play can assist in facilitating a satisfactory response to the natural environment and social settings for children with physical and cognitive disabilities.



# EIGHT SENSES

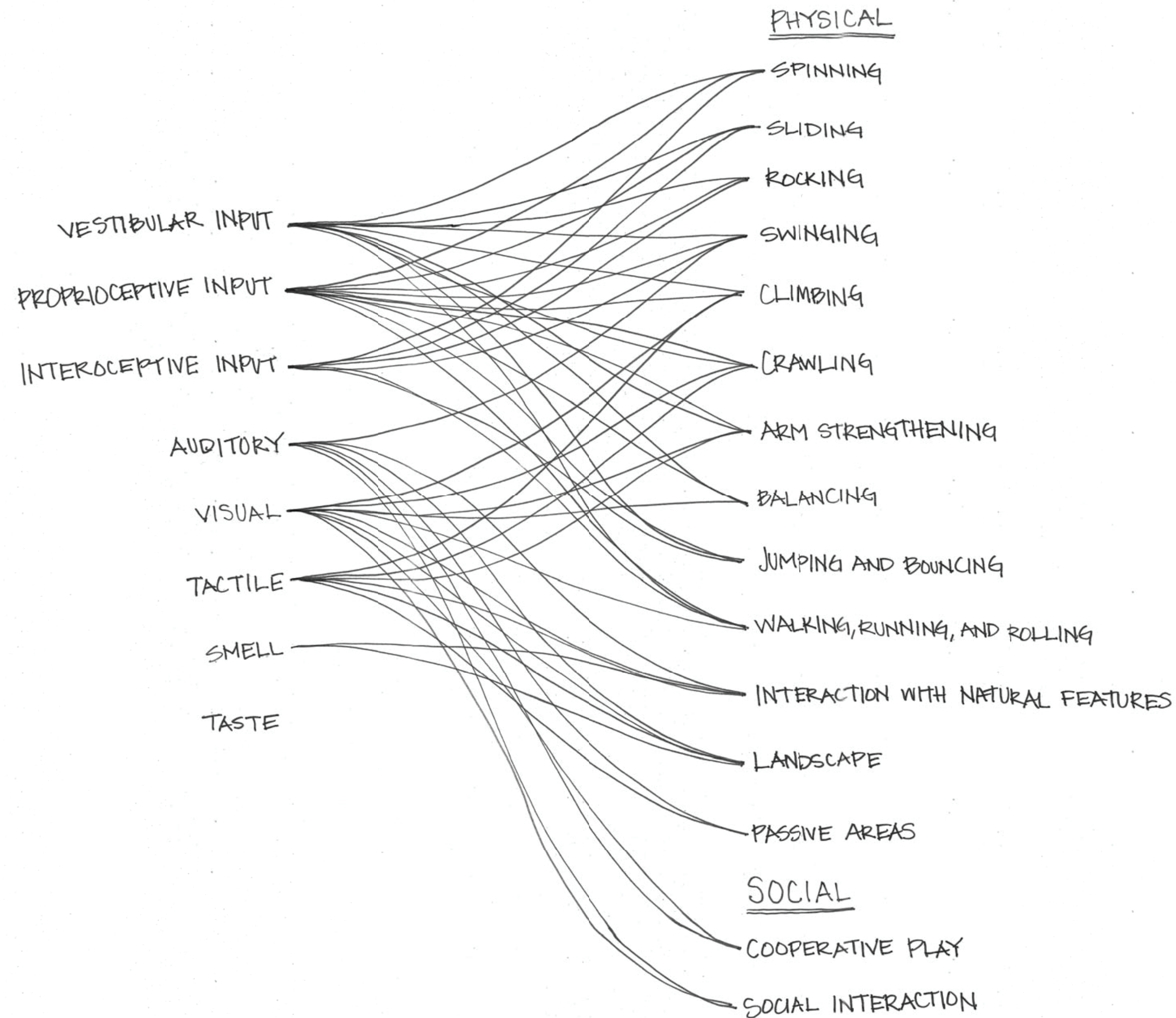

# PLAY EXPERIENCES





# POLLINATOR’S PATCH

Lily’s middle name and her love for flowers inspired this bumble bee themed concept which integrates environmental education elements into a themed play experience.

The different play zones, or “hives”, incorporate various play experiences including an active ‘worker bee’ hive, a collaborative play ‘social bee’ hive, an educational passive play hive, and a ‘young bee’ hive which encourages imaginative play. Lily’s love for flowers and her commitment to a better world for children are celebrated in this themed concept.

---



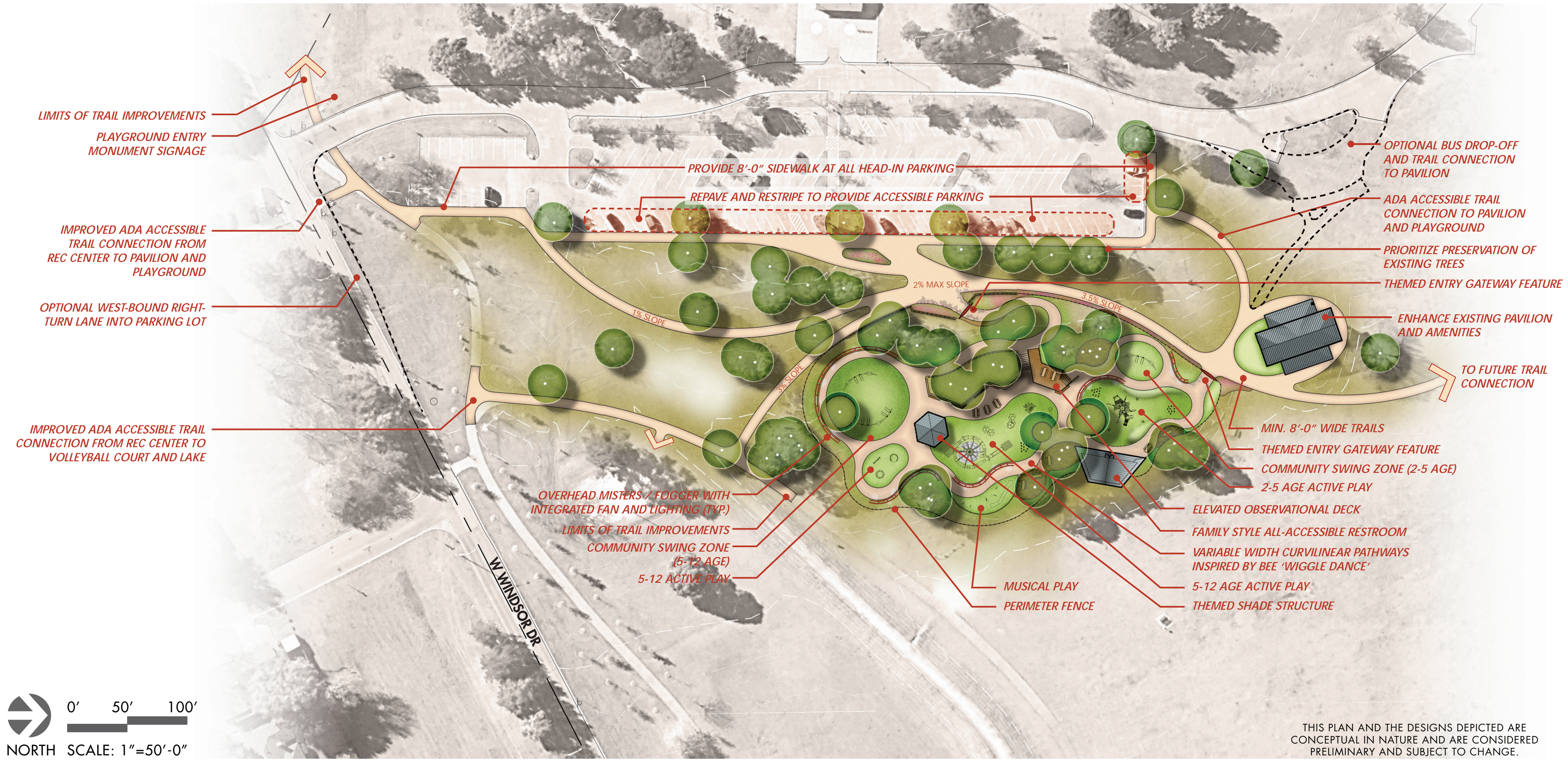

THIS PLAN AND THE DESIGNS DEPICTED ARE CONCEPTUAL IN NATURE AND ARE CONSIDERED PRELIMINARY AND SUBJECT TO CHANGE.



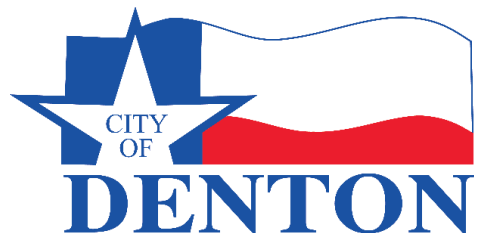
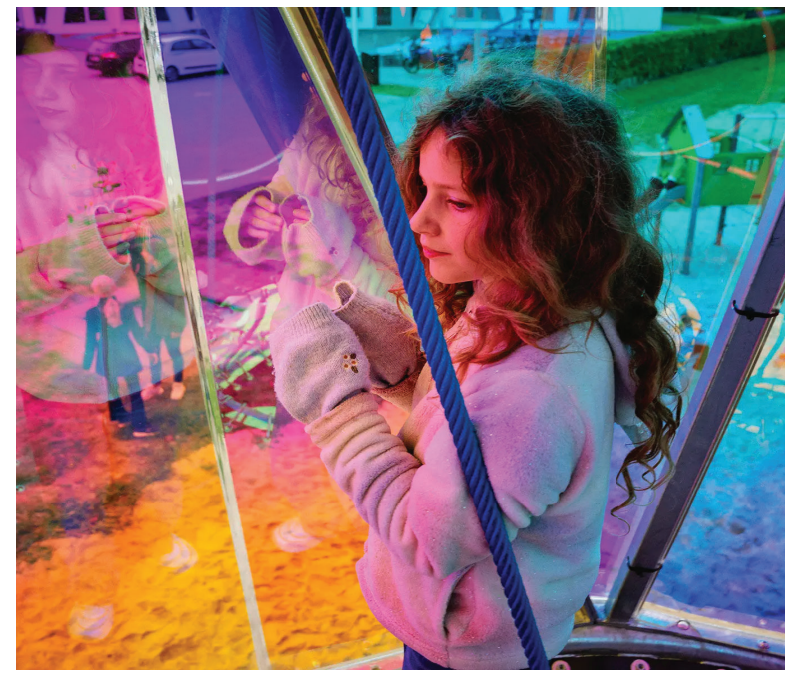

## INSPIRATIONAL IMAGERY - PLAYGROUND

LIBRADA "LILY" CANTÚ PLAYGROUND

PRB24-013

APRIL 1, 2024 | PROJECT #: 22283

4/1/2024

MESA





THEMED ENTRY GATEWAY FEATURE



SPACIOUS AND FULLY ACCESSIBLE THEMED SHADE STRUCTURE



THEMED ENTRY GATEWAY FEATURE



THEMED ENTRY GATEWAY FEATURE



FAMILY STYLE ACCESSIBLE RESTROOM WITH EXTERIOR HAND WASHING STATIONS



INCORPORATION OF AMBIENT LIGHTING



MISTERS/FOGGER WITH INTEGRATED LIGHTING AND FANS

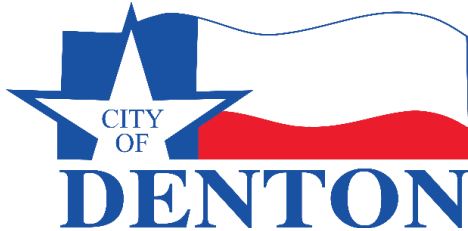

# INSPIRATIONAL IMAGERY - ARCHITECTURE

LIBRADA "LILY" CANTÚ PLAYGROUND

APRIL 1, 2024 | PROJECT #: 22283  
PRB24-013 4/1/2024

MESA





THEMED CONCRETE PATHWAYS THROUGH SELECTIVE USE OF SANDBLASTING OR INTEGRAL COLOR



THEMED CONCRETE PATHWAYS THROUGH SELECTIVE USE OF AGGREGATE



STAMPED CONCRETE PATHWAY EXAMPLE



SPACIOUS VARIABLE WIDTH PATHWAYS INSPIRED BY BEE WAGGLE DANCE



MULTI-LEVEL OBSERVATION SEATING DECK



STAMPED CONCRETE PATHWAY EXAMPLE



STAMPED CONCRETE PATHWAY EXAMPLE



INCORPORATION OF NATIVE GRASSES AND PERENNIALS AT PERIMETER OF SITE



INCORPORATION OF NATIVE GRASSES AND PERENNIALS AT PERIMETER OF SITE

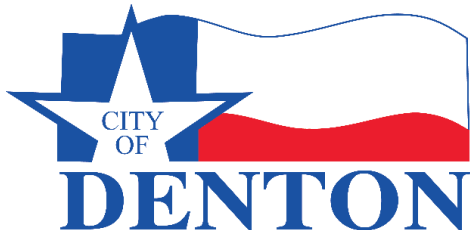

## INSPIRATIONAL IMAGERY - HARDSCAPE & LANDSCAPE

LIBRADA "LILY" CANTÚ PLAYGROUND

PRB24-013

APRIL 1, 2024 | PROJECT #: 22283

4/1/2024

MESA



# UPCOMING SCHEDULE

- |                                     |                         |
|-------------------------------------|-------------------------|
| >> Public Engagement Stage          | Currently – Summer 2024 |
| >> Seek Final Adoption              | Fall 2024               |
| >> Start Construction Documentation | Fall 2024               |
| >> Bid Project & Start Construction | Spring 2025             |
| >> Grand Opening                    | Summer 2026             |

*Subject to change pending weather or any other related design or construction delays*





**OPEN TO DISCUSSION**

MESA