

PLANT SCHEDULE							SIZE = CALIPER OR SPREAD
SYM.	SYM.	SCIENTIFIC NAME	COMMON NAME	HGT.	SIZE	CONDITION	REMARKS
SHRUBS							
+	AG	Abelia grandiflora	GLOSSY ABELIA	6'	5 GAL.		EVERGREEN / PLANT AT 4'-0" O.C.
+	ICB	Ilex cornuta 'Burfordii-Nana'	DWARF BURFORD HOLLY	6'-8'	5 GAL.		EVERGREEN / PLANT AT 5'-0" O.C.

3

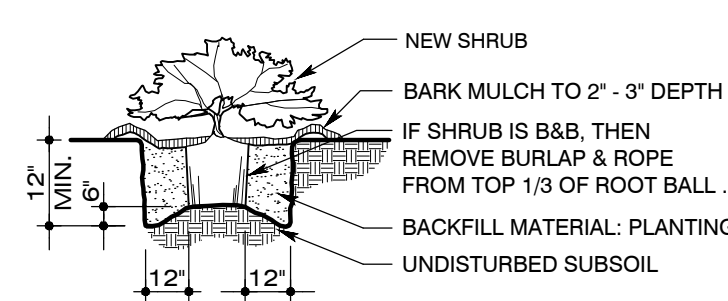

SHRUB PLANTING DETAIL
NEW SHRUBS
1/8" = 1'-0"



TREE PLANTING DETAIL
NEW TREES
1/8" = 1'-0"

GENERAL NOTES:

- REFER TO SPECIFICATIONS FOR ALL CONTRACT PLANTING.
- INSTALL APPROVED IMPORTED PLANTING MIX TO MIN. DEPTH OF 6" IN ALL AREAS SCHEDULED AS LANDSCAPE PLANTING AREAS.
- INSTALL APPROVED IMPORTED TOPSOIL TO 4" DEPTH IN ALL TURFGRASS AREAS.
- CONTRACTOR IS RESPONSIBLE FOR VERIFYING ALL QUANTITIES IN THE FIELD PRIOR TO INSTALLATION AND MUST REPORT ANY DEVIATION IN SITE CONDITIONS TO THE LANDSCAPE ARCHITECT BEFORE PROCEEDING WITH WORK IN THE AFFECTED AREA.
- WHERE SHOWN ON THESE PLANS, UTILITY INFORMATION IS PROVIDED FOR REFERENCE ONLY. REF. CIVIL AND MEP PLANS FOR ALL UTILITY INFORMATION. VERIFY LOCATION AND DEPTH OF ALL EXISTING AND PROPOSED UTILITIES PRIOR TO ANY EXCAVATION. IN THE EVENT POTENTIAL CONFLICT(S) OCCUR BETWEEN UTILITIES AND LANDSCAPE IMPROVEMENTS, IMMEDIATELY CEASE WORK IN THE AFFECTED AREA, REPORT THE CONFLICT(S) TO THE OWNER'S REPRESENTATIVE, AND DO NOT PROCEED UNTIL RECEIPT OF SPECIFIC WRITTEN DIRECTION.

URBAN DEER NOTES:

- AT THE TIME THESE DOCUMENTS WERE PREPARED THE LANDSCAPE ARCHITECT WAS NOT AWARE OF A LOCAL URBAN DEER POPULATION.
- IN THE EVENT AN URBAN DEER POPULATION IS DISCOVERED, CONTRACTOR IS SOLELY RESPONSIBLE FOR PROTECTING ALL NEWLY-INSTALLED PLANTS THROUGH THE 30-DAY MAINTENANCE PERIOD.
- APPLY "LIQUID FENCE" (OR APPROVED EQUAL) TO ALL PLANTS AS NEEDED TO DISCOURAGE BROWSING BY DEER.
- ANY NEWLY-INSTALLED PLANTS EATEN OR BROWSED BY DEER PRIOR TO THE EXPIRATION OF THE 30-DAY MAINTENANCE PERIOD SHALL BE REPLACED BY THE CONTRACTOR AT NO COST TO THE OWNER.

OVERHEAD ELECTRIC NOTES:

- ALL PROPOSED LARGE SPECIES TREES (AS DEFINED BY THE UNIFIED DEVELOPMENT CODE IN EFFECT HEREOF) SHALL BE PLANTED NO CLOSER THAN 20' TO ALL OVERHEAD ELECTRIC UTILITY LINES.
- CONTRACTOR IS SOLELY RESPONSIBLE FOR FIELD LOCATING ALL OVERHEAD ELECTRIC UTILITY LINES AND ENSURING THAT NO LARGE SPECIES TREES ARE PLANTED WITHIN 20' OF ANY OVERHEAD ELECTRIC UTILITY LINES.
- WHERE CITY INSPECTORS FIND ANY PROPOSED LARGE SPECIES TREES TO BE IN VIOLATION OF PROXIMITY TO OVERHEAD ELECTRIC UTILITY LINES, THE CONTRACTOR SHALL RELOCATE TREES AT NO ADDITIONAL COST TO THE OWNER.

TEMPORARY IRRIGATION NOTES:

- PROVIDE TEMPORARY IRRIGATION TO SODDED OR SEEDED AREAS WHERE SHOWN ON PLAN AND NOT SCHEDULED TO RECEIVE PERMANENT IRRIGATION.
- WHERE TEMPORARY IRRIGATION IS REQUIRED, PROVIDE TEMPORARY IRRIGATION FOR A MIN. PERIOD OF 60 DAYS OR UNTIL A GRASS STAND IS FULLY ESTABLISHED (AS DETERMINED SOLELY BY THE OWNER'S REPRESENTATIVE).

TREE RELOCATION NOTES:

- RELOCATION CONTRACTOR QUALIFICATIONS**
 - Qualified contractor shall demonstrate successful relocation of a min. of five (5) trees of similar size and species in areas with a similar climate within the past five (5) years.
 - Contractor shall submit shop drawings as directed herein for review and approval prior to execution of the related work.
 - Contractor is solely responsible for the mortality of the relocated tree as stipulated in his contract with the Owner.
- PRE-TRANSPLANT CARE**
 - Place tree to be relocated on a hydration schedule prior to relocation to receive water per the following schedule:
 - May through September: a minimum of 400 gallons of water every 3 days.
 - October, March, and April: a minimum of 300 gallons of water every 4 days.
 - November through February: a minimum of 200 gallons of water every 5 days.
 - Dead-wood tree to be relocated and thin canopy by approximately 15%.
 - Root-prune tree to be relocated by hand to a depth of 30 inches should take place as far in advance of the relocation as possible, but not less than (7) days prior.
 - Backfill the root prune trench completely backfilled to ensure that all air pockets are removed.
 - Install an approved vapor barrier between root pruning and relocation.
- ROOTBALL PREPARATION**
 - Excavate the rootball with a minimum diameter of 12 times the caliper of the tree (measured 12" above finish grade at the base) and a minimum depth of 48" (measured from existing finish grade).
 - Hand-construct and completely encapsulate the rootball with burlap, a field fence, and an approved vapor barrier.
 - Construct a steel pipe-and-rail lifting platform beneath the rootball sized adequately to support the weight of the tree and rootball. Cable-cut the rootball to detach any remaining structural roots.
- TRANSPLANTING**
 - Obtain written approval and field identification of final location of the tree to be relocated.
 - Excavate the planting pit at the approved location to a depth sufficient to accommodate the width of the steel pipes forming the lifting platform, the depth of the rootball, and a 4" crown from finish grade at the base of the tree to the pit perimeter. **DO NOT OVER-EXCAVATE THE DEPTH OF THE PIT.**
 - Excavate the planting pit at the approved location to a width sufficient to allow the relocated tree to be oriented as desired by the Owner.
 - Obtain Owner's approval of the relocated tree's location and orientation prior to de-mobilizing equipment.
 - Install (4) vertical pieces of 4" perforated PVC (one at each quadrant of the rootball's perimeter) such that the base of each pipe rests on top of the undisturbed subgrade at the bottom of the pit and the top of each pipe extends 6" above finish grade (allowing for 3" of bark mulch topdress). Provide caps for each piece of PVC pipe.
 - Backfill the planting pit sides with planting mix per Specifications - see Sheet L2.0.
 - Provide hardwood bark mulch to depth of 3" from edge of root flare to perimeter of planting pit.
- IRRIGATION**
 - Install (4) tree bubblers (one per quadrant) @ rootball perimeter.
 - Provide separate electric valve and circuit for tree bubblers on relocated tree and wire into clock @ overall site irrigation system.
 - Submit shop drawing of proposed bubbler irrigation for approval prior to installing.
 - Coordinate tree bubblers @ relocated tree with new irrigation system and clock to be installed w/ other improvements.
- POST-TRANSPLANT CARE**
 - Provide consistent water to the relocated tree such that regular water is available to the tree without creating a continuously wet condition (i.e., the rootball should be allowed to dry between waterings).
 - Monitor precipitation patterns at the project site such that water is provided according to the following schedule:
 - June through August: Water 3 times per week.
 - September and October: Water 2 times per week.
 - November through February: Water 1 time per week.
 - March through May: Water 2 times per week.
 - Do not prune during the first year. In subsequent years, remove lower limbs and downward growth as desired. To discourage spread of Oak Wilt and Live Oak Decline, prune only between December and February and paint all wounds within 30 minutes of cutting. Refer to Tree Pruning Detail.
 - Maintain 3" of hardwood bark mulch over the rootball.
 - Maintain finish grade @ rootball free of turfgrass and weeds. Hand weed only - do not mow, edge, or weedeat within rootball area.
 - Do not disturb the rootball or install any container plants within rootball.
 - Do not trench or cut the rootball.
- BIDDING INFORMATION**
 - Contractor shall visit the project site prior to submitting a bid for tree relocation and familiarize himself fully with all existing site constraints that may impact the tree relocation. A Geotechnical Report is available upon request.
 - Base bid for tree relocation is to include any and all labor, materials, and coordination necessary to relocate (2) existing 4" cal. red oak trees (measured 12" above the base) and transplant to proposed locations per landscape planting plan.
 - Contractor shall provide Unit Prices for the following (to be used for Adds and Deletes only):
 - Unit Price for tree relocation for each caliper inch the existing live oak tree is field-measured above or below 24".
 - Unit Price for transplanting the existing live oak tree for each linear foot above or below 63 feet from its present location.
 - Upon acceptance of the tree relocation by the Owner and prior to the final payment, Contractor shall provide to the Owner a written report describing recommended long-term maintenance and care instructions for the relocated tree. The report shall include at a minimum the following information:
 - A 12-month recommended Watering Schedule.
 - Any recommended fertilizing and pesticide program.
 - A recommended pruning schedule.

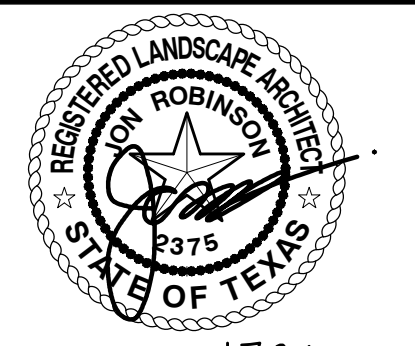
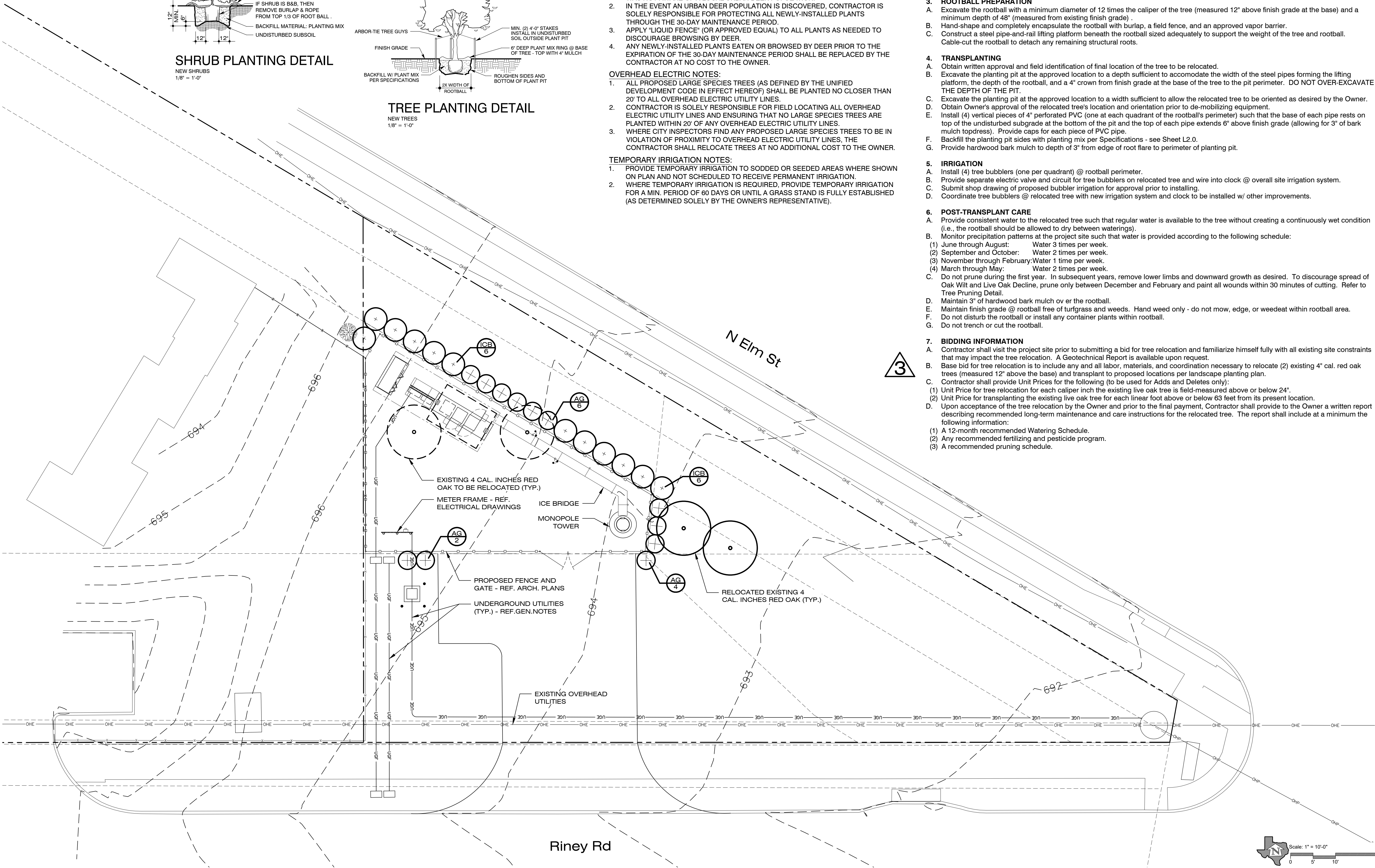

The user of this file agrees to assume all responsibility for any modifications to or use of this drawing file that is inconsistent with the requirements of the Rules and Regulations of the Texas Board of Architectural Examiners. No person may make any modifications to this electronic drawing file without the Landscape Architect's express written permission.

OWNER
APC TOWERS

8601 Six Forks road #2500
Raleigh, NC 27615

PROJECT
**Bonnie Brae
Cell Tower Denton TX**

N Elm Street & Riney Road
Denton, TX 76207

REVISIONS

1. Site Changes	8/25/25
2. City Comments	9/29/25
3. City Comments	1/7/26

PROJECT NUMBER
2025-028

Drawn By: al
Checked By: jr

Sheet Title:
**LANDSCAPE
PLANTING PLAN**

Sheet Number:

L1.0

Issue Date:
April 30, 2025

