

**BATESMARTIN ARCHITECTS**  
 Michael A. Bates, Architect  
 2220 San Jacinto Blvd., Suite 330 Denton, TX 76205 (940)387-4881  
 © Bates & Martin Architects, LLC. All rights reserved.

**SITE PLAN FOR:**  
**3650 SHELBY LANE**  
 BLOCK C, LOT 7 CORBIN ROAD INDUSTRIAL PARK  
 3650 SHELBY LANE DENTON, TEXAS 76207

ZONING DISTRICT HI  
 ZONING DISTRICT ADJACENT LOTS:  
 NORTH: HI  
 EAST: HI  
 SOUTH: HI  
 WEST: HI  
 SITE NOTES:  
 1) PROPERTY IS NOT IN THE FLOOD PLAIN.  
 LOT AREA: 347,192 S.F.  
 PREVIOUS AREA: 56,734 S.F. (16.3%)  
 IMPREVIOUS AREA: 290,458 S.F. (83.7%)  
 PARKING REQUIRED: 61490 S.F. / 3,500 S.F. = 18  
 PARKING PROVIDED: 30

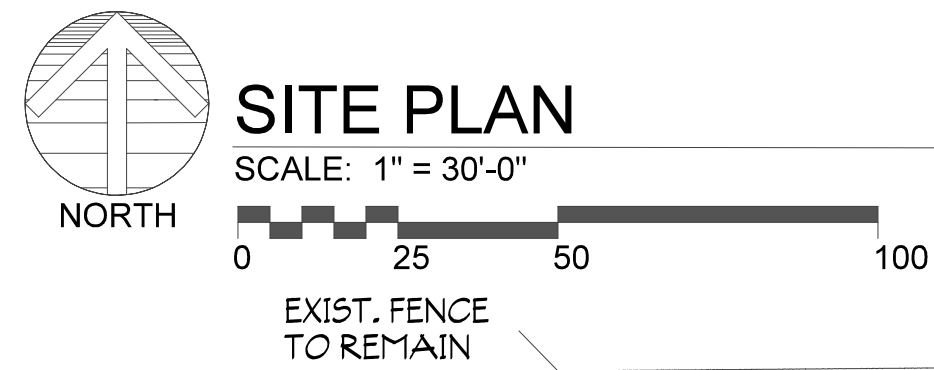
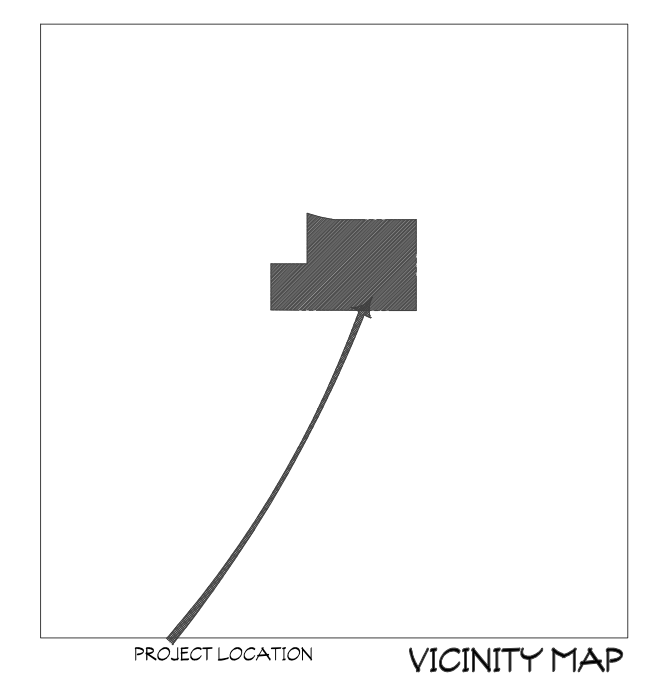

April 12, 2024

REV. 2/5/2024

SHEET  
**A1**