

S25-0007

Future Land Use Map

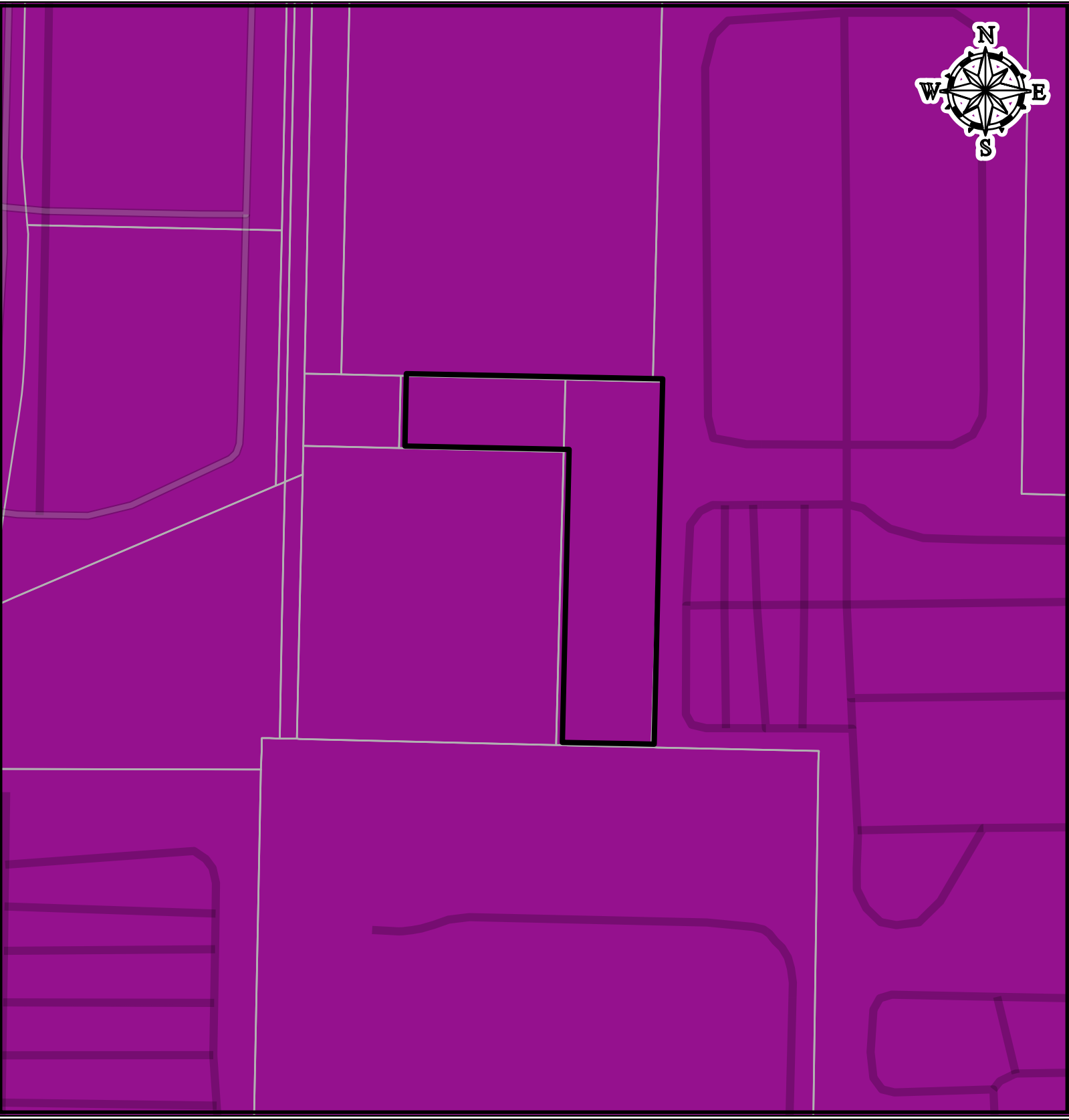

Future Land Use 2040

- Agriculture
- Rural Areas
- Low Residential
- Moderate Residential
- Master Planned Community
- Downtown Denton
- Regional Mixed Use
- Community Mixed Use
- Neighborhood Mixed Use
- Neighborhood / University Compatibility Area
- Business Center
- Light Industrial
- Industrial Commerce
- Government / Institutional
- Parks / Open Space
- Site Location

0 75 150 300 Feet

"This product is for informational purposes and may not have been prepared for or be suitable for legal, engineering, or surveying purposes. It does not represent an on-the-ground survey and represents only the approximate relative location of property boundaries. Although every effort was made to ensure the accuracy of this data, no such guarantee is given or implied. Utilization of this map indicates the understanding that there is no guarantee to the accuracy of this data."