

Z25-0004

Future Land Use Map

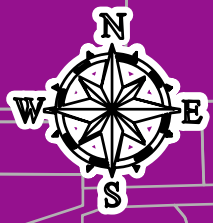
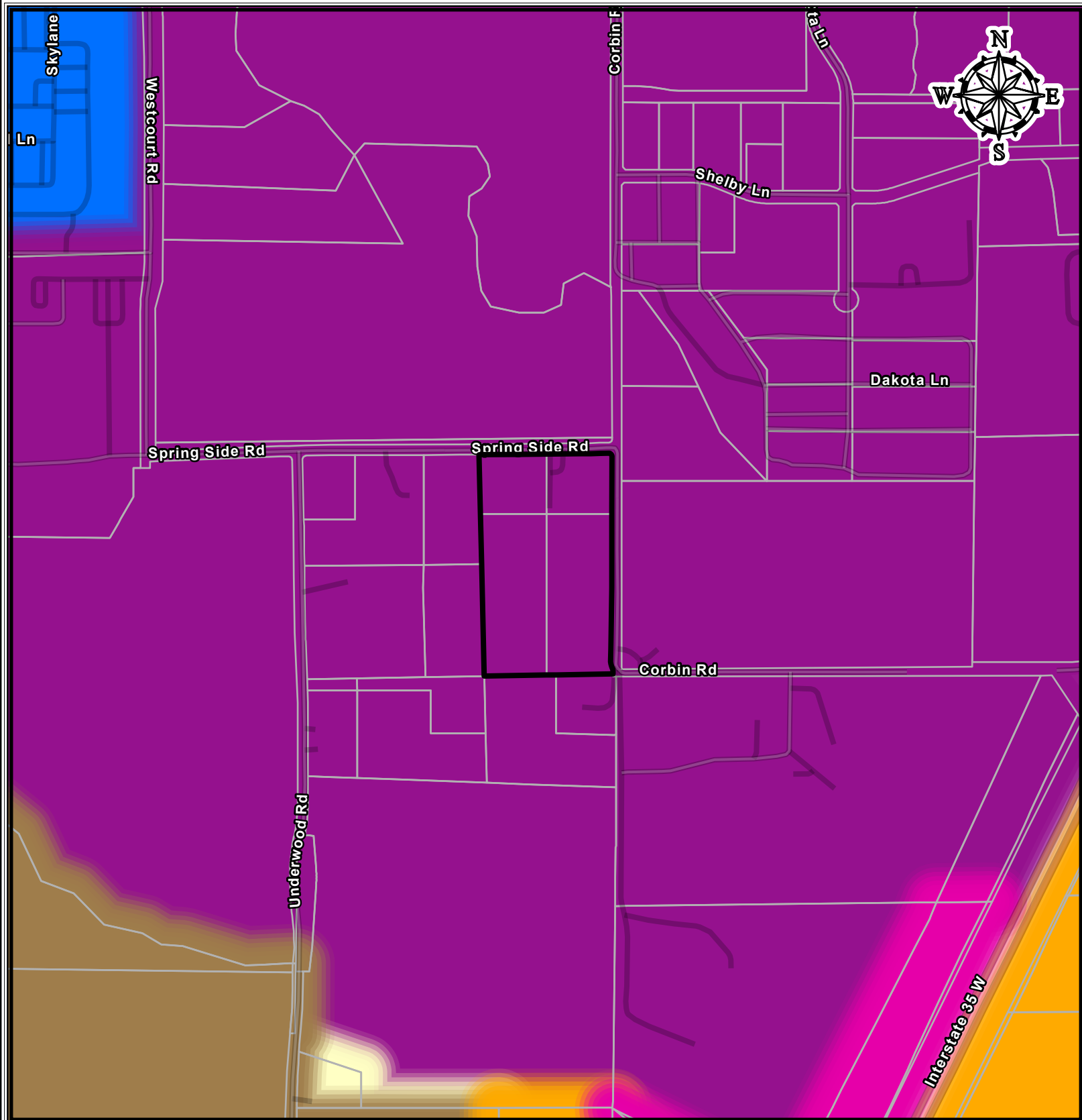

Interstate 35 W

Future Land Use 2040	
Agriculture	Neighborhood Mixed Use
Rural Areas	Neighborhood / University Compatibility Area
Low Residential	Business Center
Moderate Residential	Light Industrial
Master Planned Community	Industrial Commerce
Downtown Denton	Government / Institutional
Regional Mixed Use	Parks / Open Space
Community Mixed Use	Site Location

CITY OF DENTON
Development Services • GIS
Date: 2/27/2025

"This product is for informational purposes and may not have been prepared for or be suitable for legal, engineering, or surveying purposes. It does not represent an on-the-ground survey and represents only the approximate relative location of property boundaries. Although every effort was made to ensure the accuracy of this data, no such guarantee is given or implied. Utilization of this map indicates the understanding that there is no guarantee to the accuracy of this data."